

Site planning and Shelter Camp Restructure Project

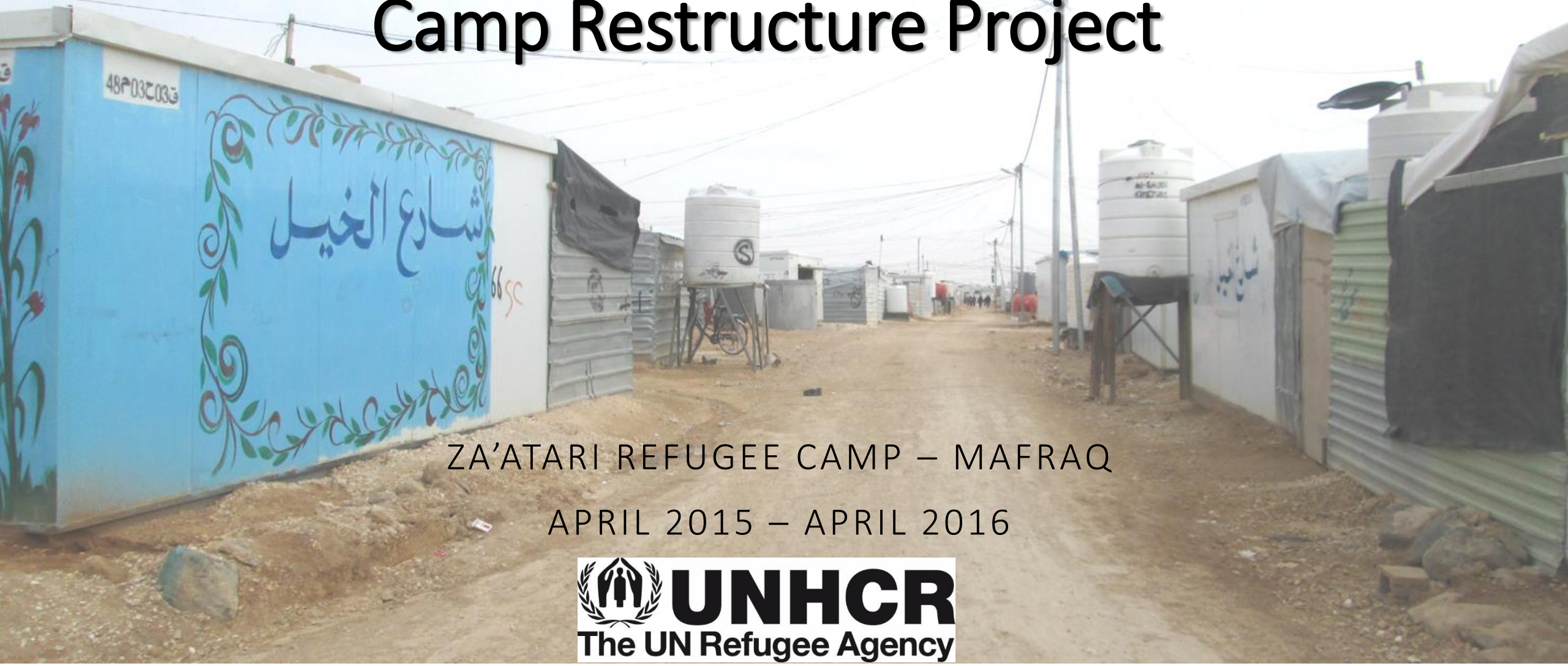

ZA'ATARI REFUGEE CAMP – MAFRAQ

APRIL 2015 – APRIL 2016

Introduction



Zaatari Camp was opened in July 2012. A high influx of refugees passed through Zaatari with varying duration of stay causing challenges to shelter allocation and camp structure.

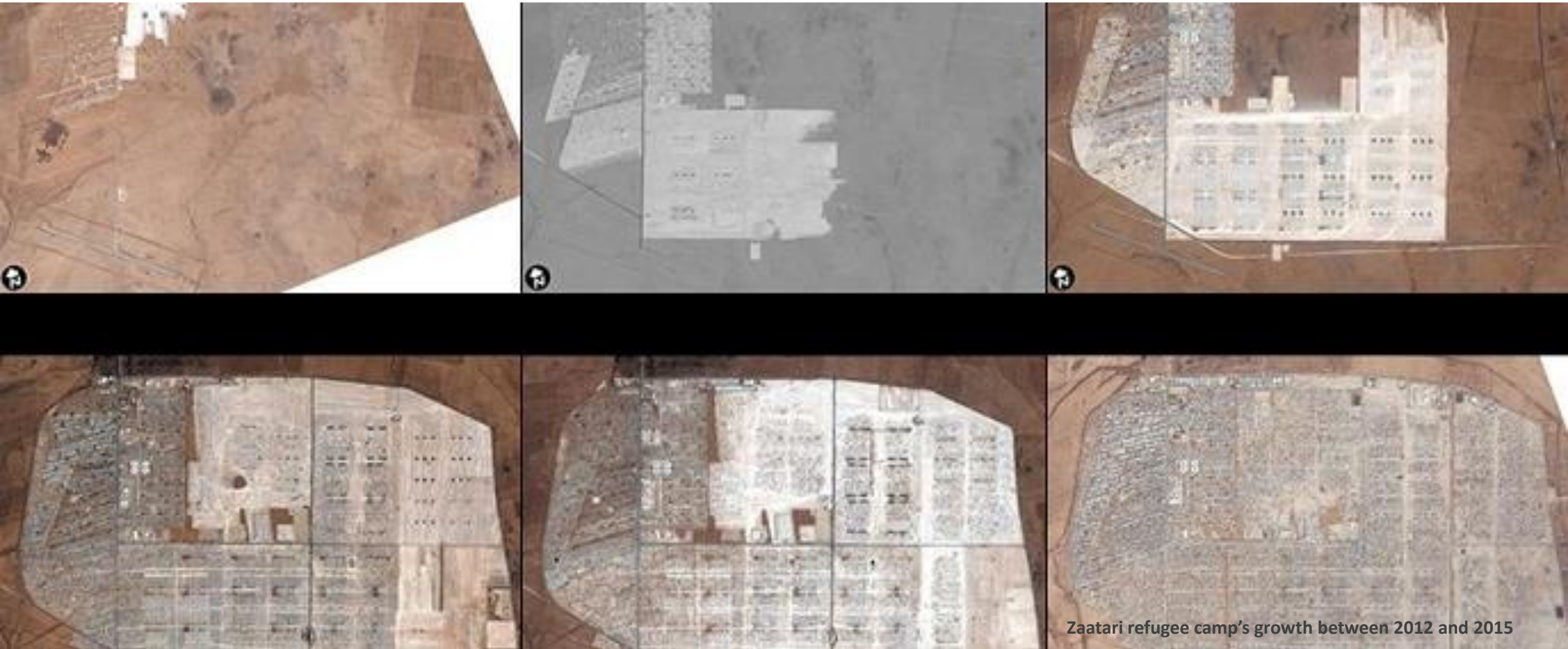

Zaatari refugee camp's growth between 2012 and 2015



An aerial view shows the Zaatari refugee camp on July 18, 2013.



- There are different types of shelter provided in the camp, i.e. tents and mobile caravans.
- Method of pitching tents, distributions and recovery of shelter was not fully systemized from the beginning of the camp establishment.
- Shelter recovery started July 2014 by tracking of refugees leaving the camp.
- Different source of shelter distributions and limited recording/verification.
- Attempt to implement the camp initial master plan and make it visible on the ground.
- Refugees tend to change their location within the camp very frequently and have large household plot with many shelters.

Project Vision

An aerial photograph of a large, densely packed refugee camp. The camp is composed of numerous small, rectangular structures, likely tents or simple huts, arranged in a grid-like pattern. A prominent, wide, light-colored path or road runs diagonally through the center of the camp. In the upper-middle section, a larger, more organized area is highlighted with a semi-transparent white box, showing several larger, more uniform buildings and a central open space. The overall scene depicts a vast, organized settlement in a dry, arid environment.

“Camp restructure is an attempt to best utilize the camp space in line with minimum standards and preserve social cohesion to the maximum extent possible.”

Methodology

- Population of Zaatari camp stabilized since opening of Azraq camp. Currently, the camp is home to some 80,000 refugees HH residing in 12 districts.
- New shelter design was introduced in January 2015: prefab includes concrete flooring, built-in wash and cooking facilities as in the below layout:

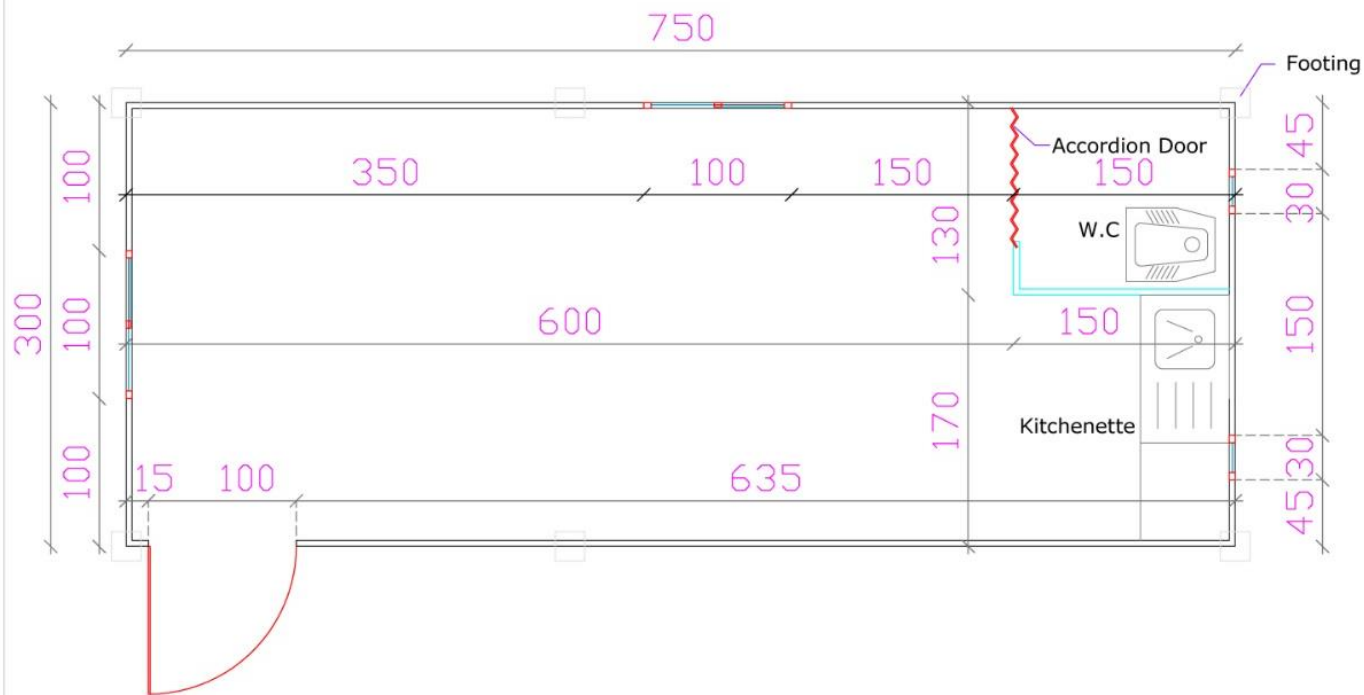

Methodology

- **Needs Assessment and assistance of households through home visits and consultations with refugees.**
- **Relocation of HH when needed to reflect the camp masterplan skeleton .**
- **Roll out of address system in the camp and linked to UNHCR file #. An attempt to implement the camp initial master plan and make it visible on the ground.**
- **Produce as-built plan for the camp: final and accurate layout to be used as camp masterplan.**
- **Identify full camp capacity and empty plots**
- **HH will be linked to infrastructure networks, i.e. waste water, water supply, electricity and construction of service roads.**

Zaatari Masterplan

Zaatari Refugee Camp
MAFRAQ . JORDAN

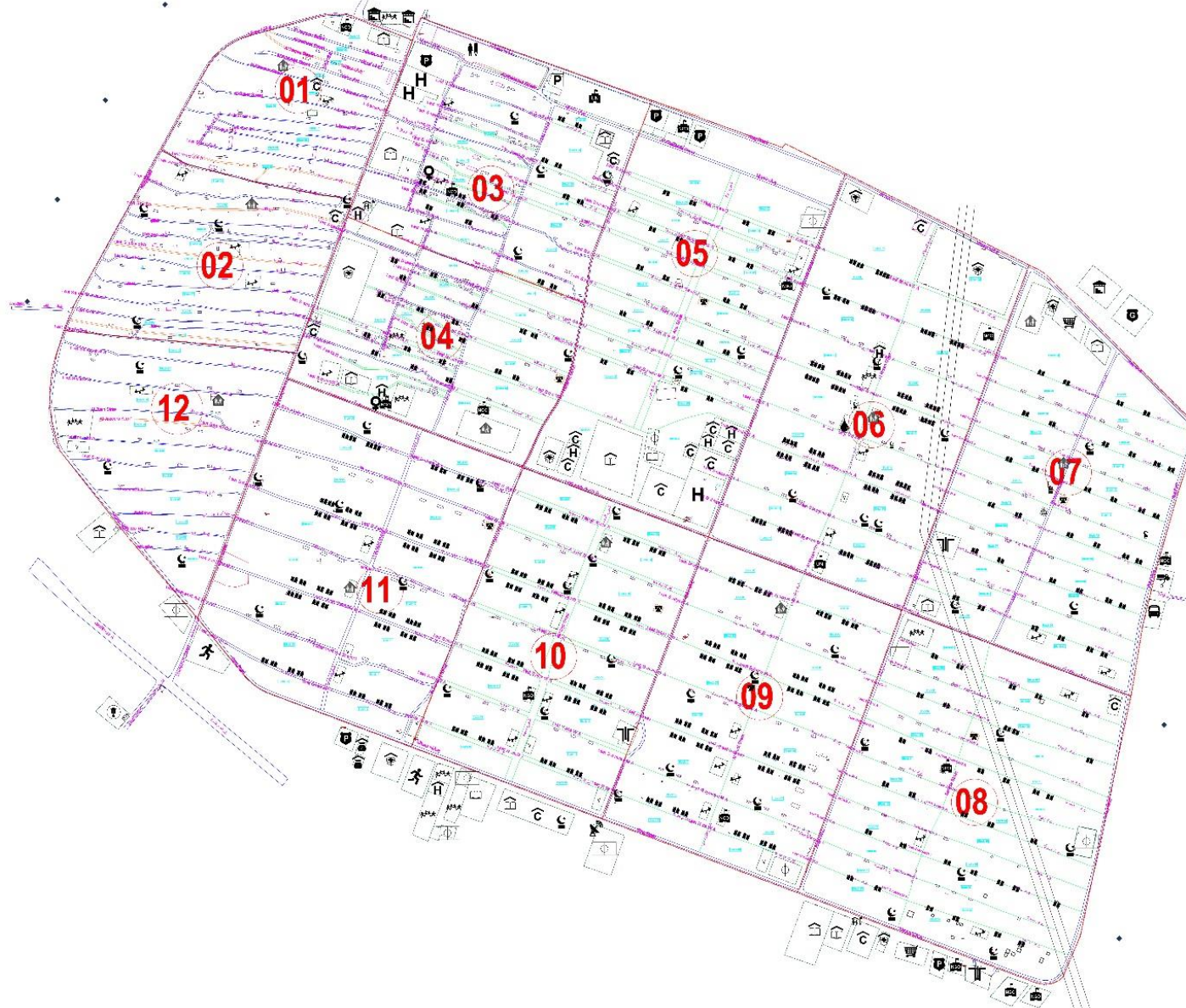

GENERAL INFRASTRUCTURE

- | | |
|----------------------|-----------------------------|
| ⊕ Assembly point | 🏠 Hotel |
| 🏥 Clinic | 🏠 House |
| 🏢 Community building | 🏢 Infrastructure |
| 🏢 Diplomatic mission | 🚚 Mobile clinic |
| 🏢 Distribution site | 🕌 Mosque |
| 🏢 Food warehouse | 🏢 NGO office |
| 🏢 Government office | 👮 Police station |
| 🏠 Health facility | 🎓 School |
| 🏠 Health post | 🏢 UN compound/office |
| H Hospital | 🛒 Supermarket |
| 👤 Registration | 👦 Children playground |
| 🚗 Bus Station | 👮 Gendarmerie |
| 🏢 Warehouse | 🏃 Sports Center |
| 👦 Youth Center | 🏠 Informal Education Center |
| P Parking Area | 📡 Telecommunications Center |
| ♀ Women Center | |

WATER, SANITATION & HYGIENE

- | | |
|------------------------|------------------------------|
| 🏠 Borehole | 🏠 Spring Water |
| 🏠 Communal latrine | 🏠 Submersible pump |
| 🏠 Latrine cabin | 🚽 Toilet |
| 🏠 Potable water | 💧 Water source |
| 🏠 Potable water source | 🚚 Water trucking |
| 🏠 Sanitation | 🏠 Well |
| 🚿 Shower | 🏠 Wastewater Treatment Plant |
| 🗑️ Solid Waste | |

EDUCATION

- | |
|------------------------------|
| 🎓 School yard + Sports field |
| 🎓 Vocational Training centre |
| 👮 Gendarmerie station |

DRAWING DESIGNATION: District 8 - Vacant Shelter Locations

SCALE : To Fit

ARCH/PSP NAME: Mohamed Jertila
Ghada Barakat

MODIFIED DATE : 26/11/2015

Shelter Images



Shelter Images



Assessment Questions

District	Block	REACH Address	Household Area (m ²)	Is this HH inhabited?	Is this HH a compound or single family?	Number of families living in this HH
----------	-------	---------------	----------------------------------	-----------------------	---	--------------------------------------

Private facilities in this HH	Type of shelter (observed)	Number of Caravans (observed)	Caravans: fixed, mobile or both	Number of tents (observed)	Does this HH have an extension/porch?
-------------------------------	----------------------------	-------------------------------	---------------------------------	----------------------------	---------------------------------------

Main material of extension/porch	Registration number: manual	Name of head of household	Total number of persons with physical disabilities in this HH	Total number of pregnant women this HH	Age of individuals (years)	Gender of individual
----------------------------------	-----------------------------	---------------------------	---	--	----------------------------	----------------------

JORDAN - Al Za'atari Refugee Camp
Household Boundaries - District 4 - Blocks 1-13

Not for Circulation

For more information, scan to visit the Open Street Map Portal

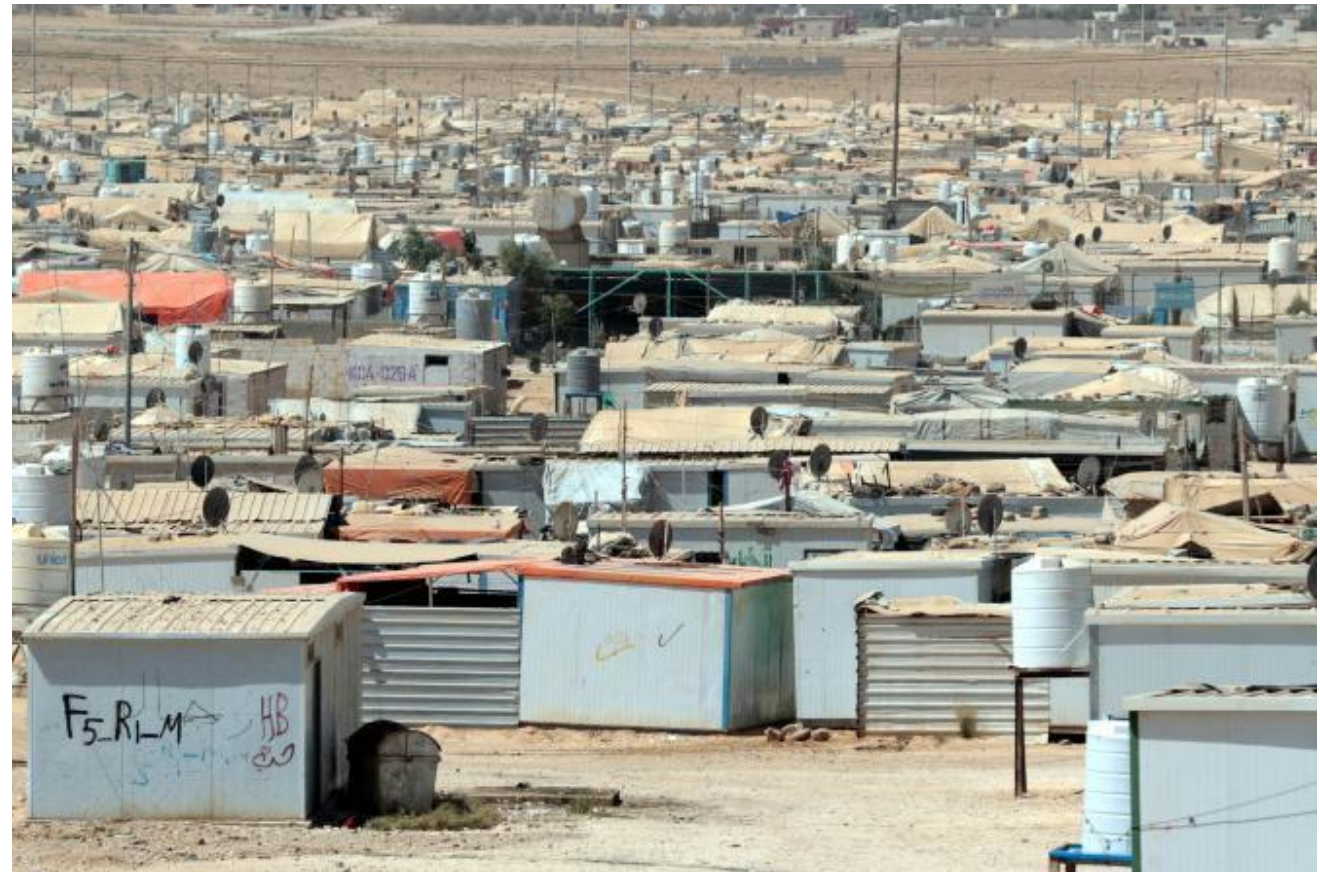
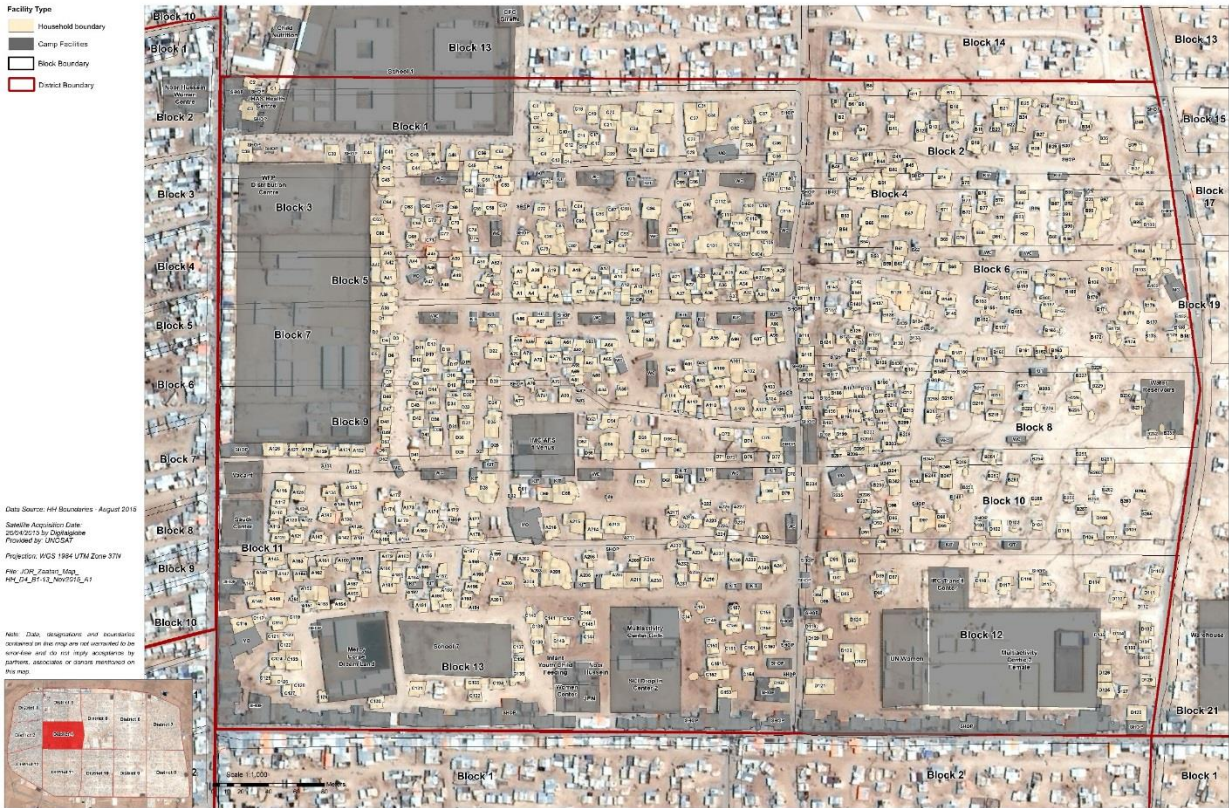

Blocks Layout

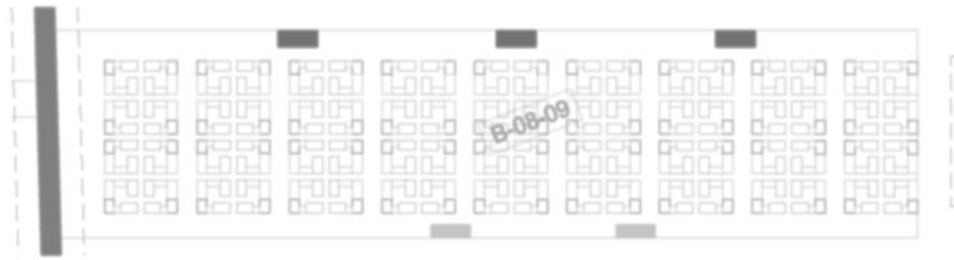

Pathways of 6m are left between every column of HH to provide access to services and respond to emergencies.

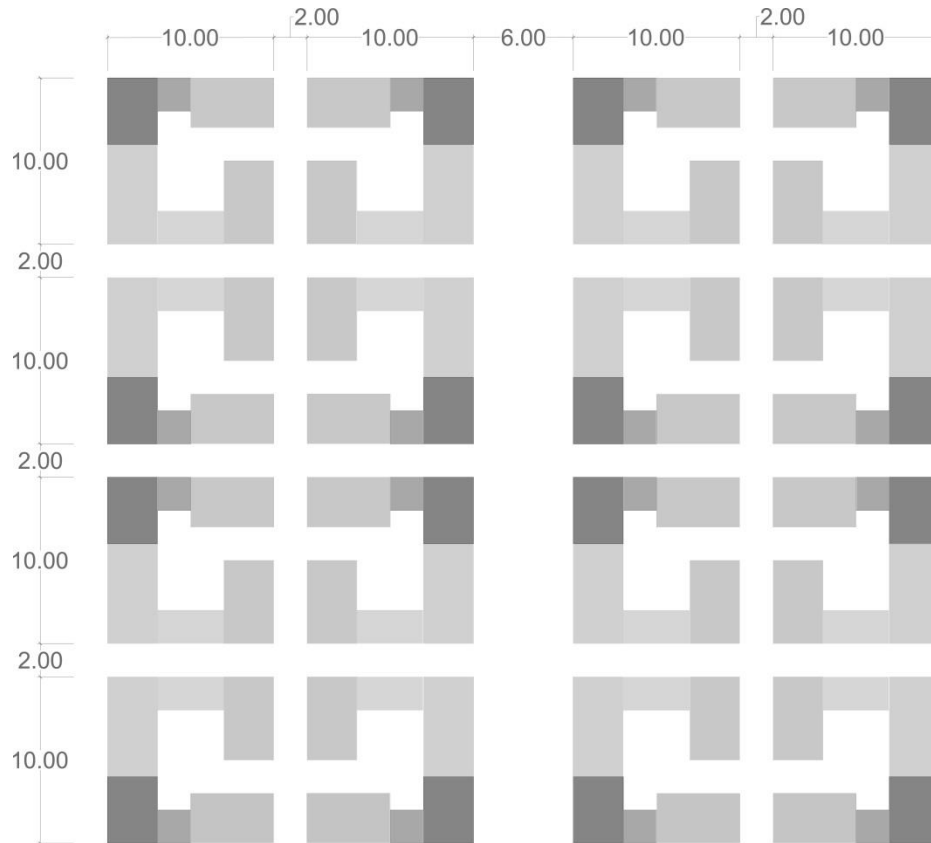

Household Plot:

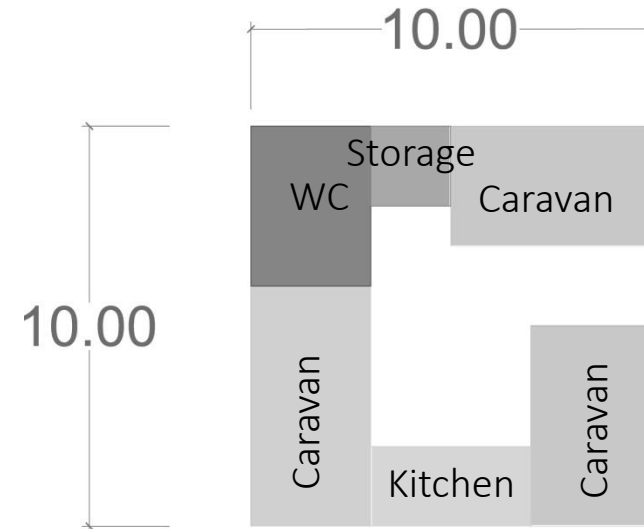

Each HH will have approx. 10x10m plot size to fit their caravans, tents, and installations.

Addressing system

After restructuring and relocation: each HH will have an address number printed that shows district #, block #, and HH #, and street names will be painted on caravan elevations as per the below image:

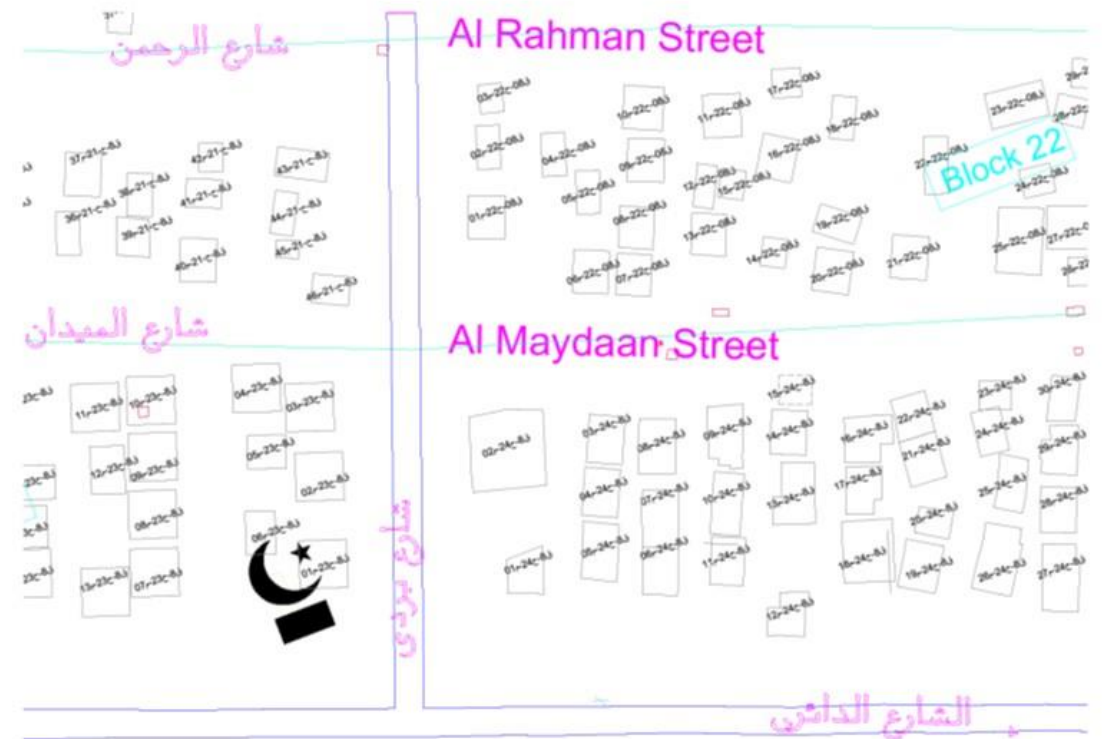
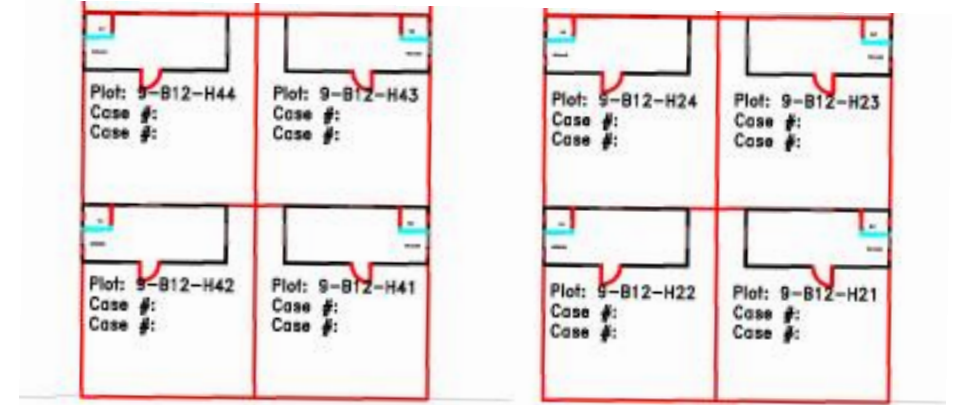

NRC Responsibilities

- Implementing all the activities which ensure accessibility and security for each Household.
- Represent accurate as-built master plan for the whole Zaatari Camp and its features optimistically.
- Implementing the address system in the camp, including demarcating HH numbers and street names.

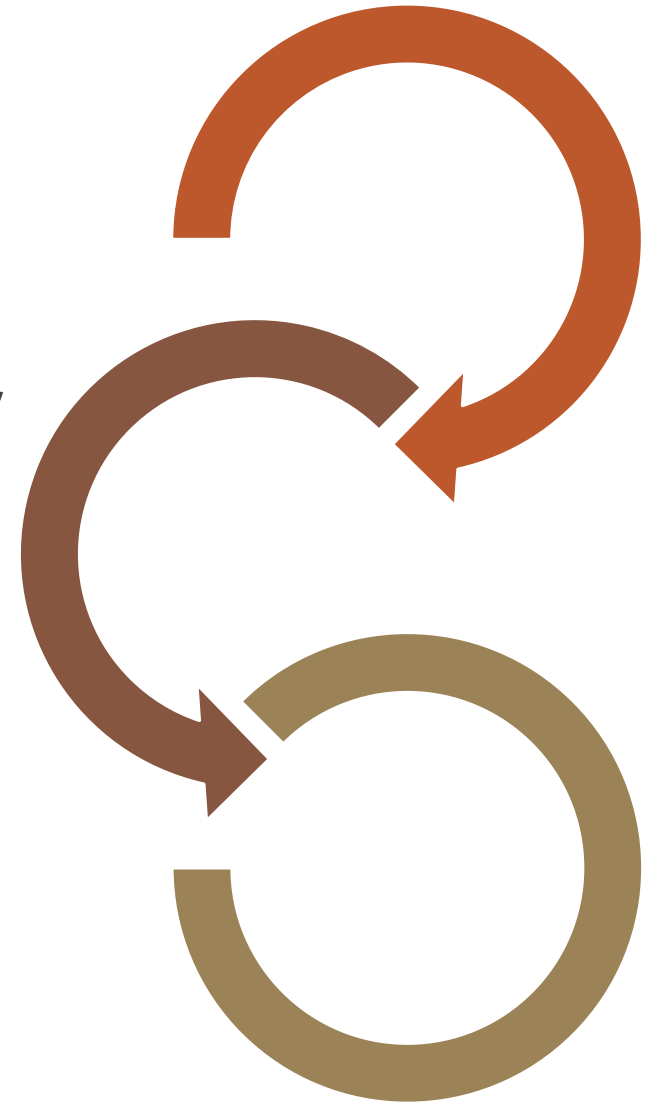

NRC Team Duties

1. Households Allocation and Relocation

- Implementing relocation plans , activities, messages, resolving any related issues on the site; which ensure accessibility and security for each Household.
- Demarcating prefabricated caravans and its classifications onsite to allocation activities

2. Surveying

- Measuring the distance and angles in order to create the As-built maps after relocation activities

3. Address Planning

- Identifying the address for each household and handing over the final drawings on a specific sequence for address implementation team.
- Drawing the final As-built layouts for each blocks as is approved.

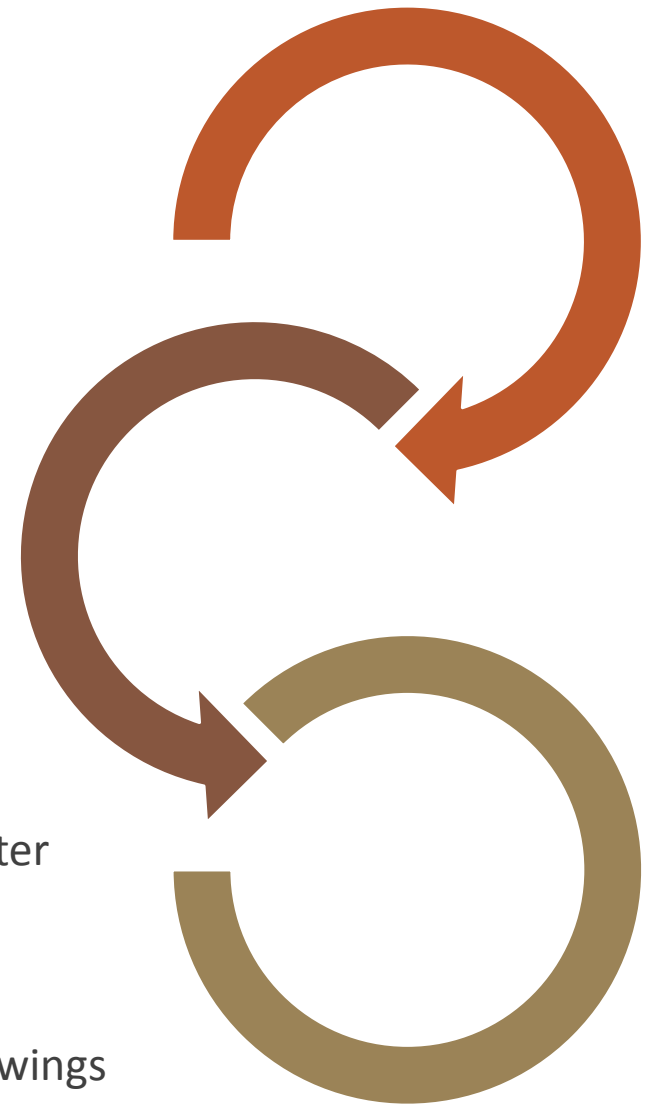

4. Address Implementation

- Installing the address of each HH in the field.
- Demarking the names of each street as provided in the masterplan.

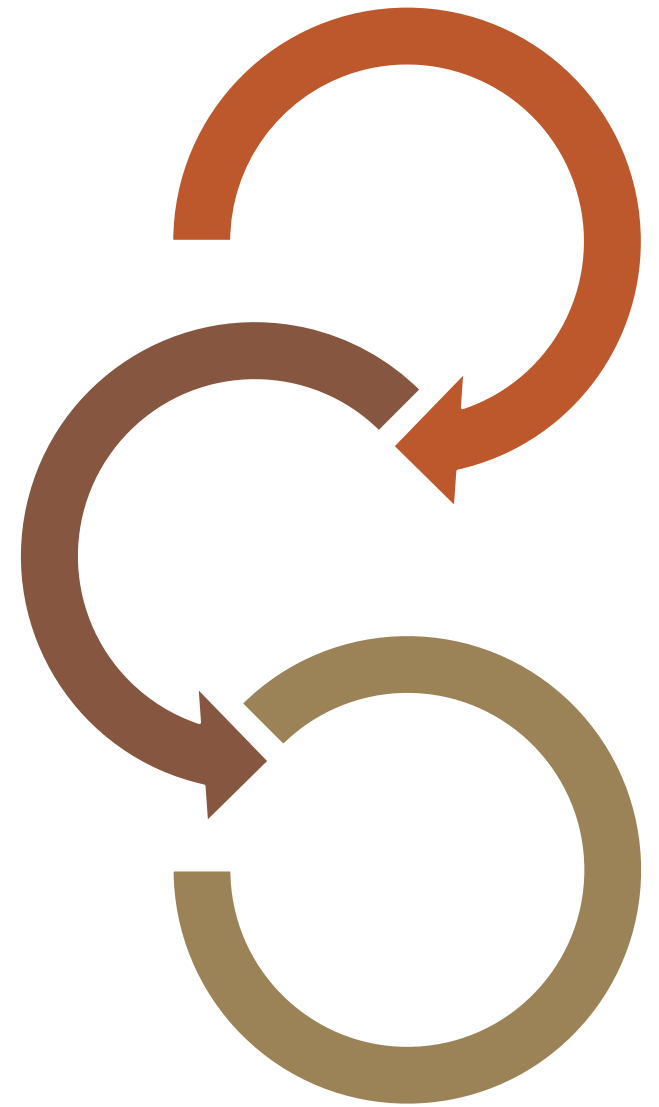

1. Allocation and Relocation Team

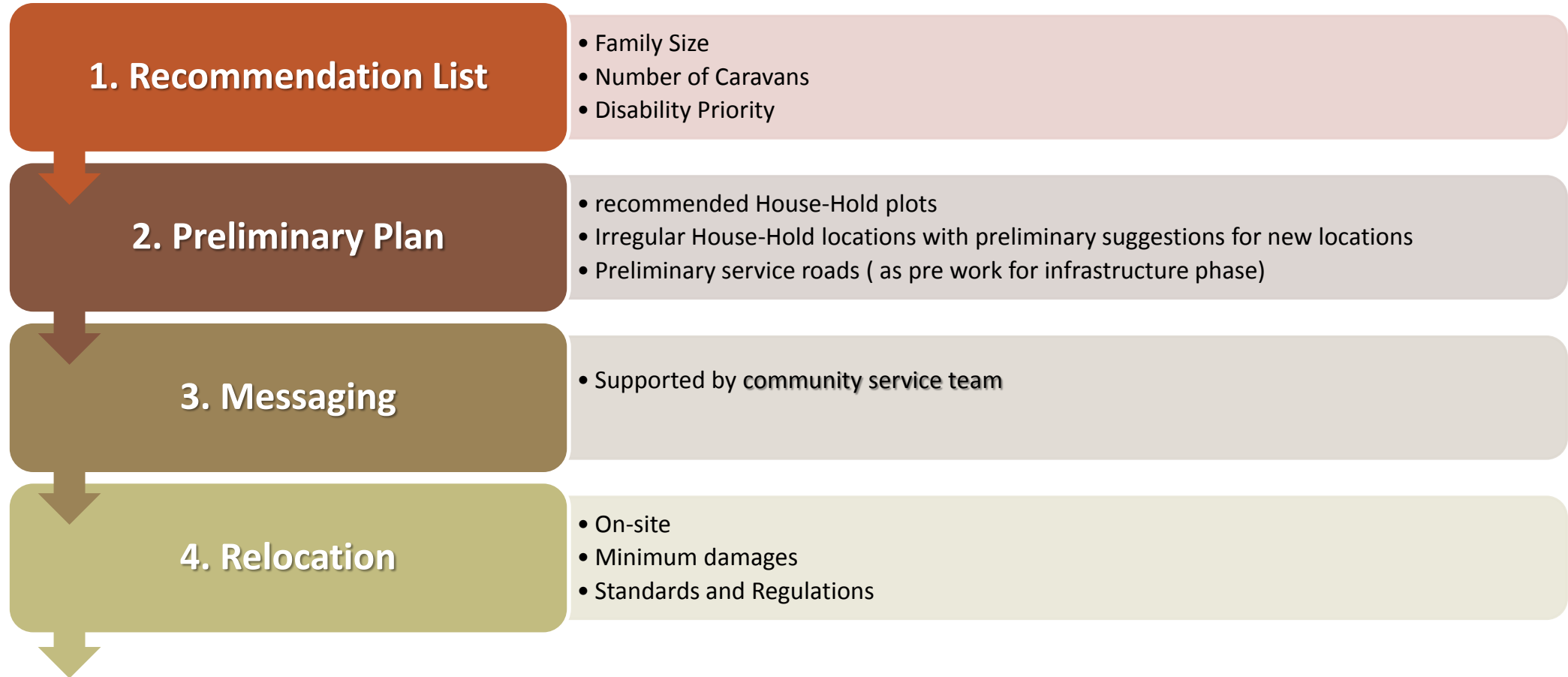



→ “ To guarantee a well sewer service, privacy, and safety for each House-Hold (with minimum damages), in parallel with the project regulations, and demarcate a prefab caravan/s” ←







Allocating the recommended prefab caravans by RAF, based on Relocation team's updated maps.

5. Updated Maps

- CAD plans for each block, shows the new locations for Prefab, relocated Caravans, and new service roads.
- Daily relocated and allocated caravans' progress
- Prepare tables show the Allocated and Returned Caravans' types (A or B), Household full information, and any back-up notes.



2. Surveying Team

→ make exact coordinates, measurements and determine all the household boundaries, and provide data relevant to the shape, location, and dimension of each district, its features, and house-holds on-site
←



1. Find Master Bench-marks

- Based on Handel GPS and existing landmarks

2. Allocating the Global BMs in the camp

- Using Palestinian Grid
- Accuracy less than 1m



3. Specific NRC Surveying Network

- Dividing new benchmarks
- Connect them for a geometric network cover the district
- Accurate produced master plan

4. Surveying As-built Map

- For every caravan and major features in the each block (Easting , Northing)
- Code all the points for the observed features in site
- In coordination with relocation and Address planning teams





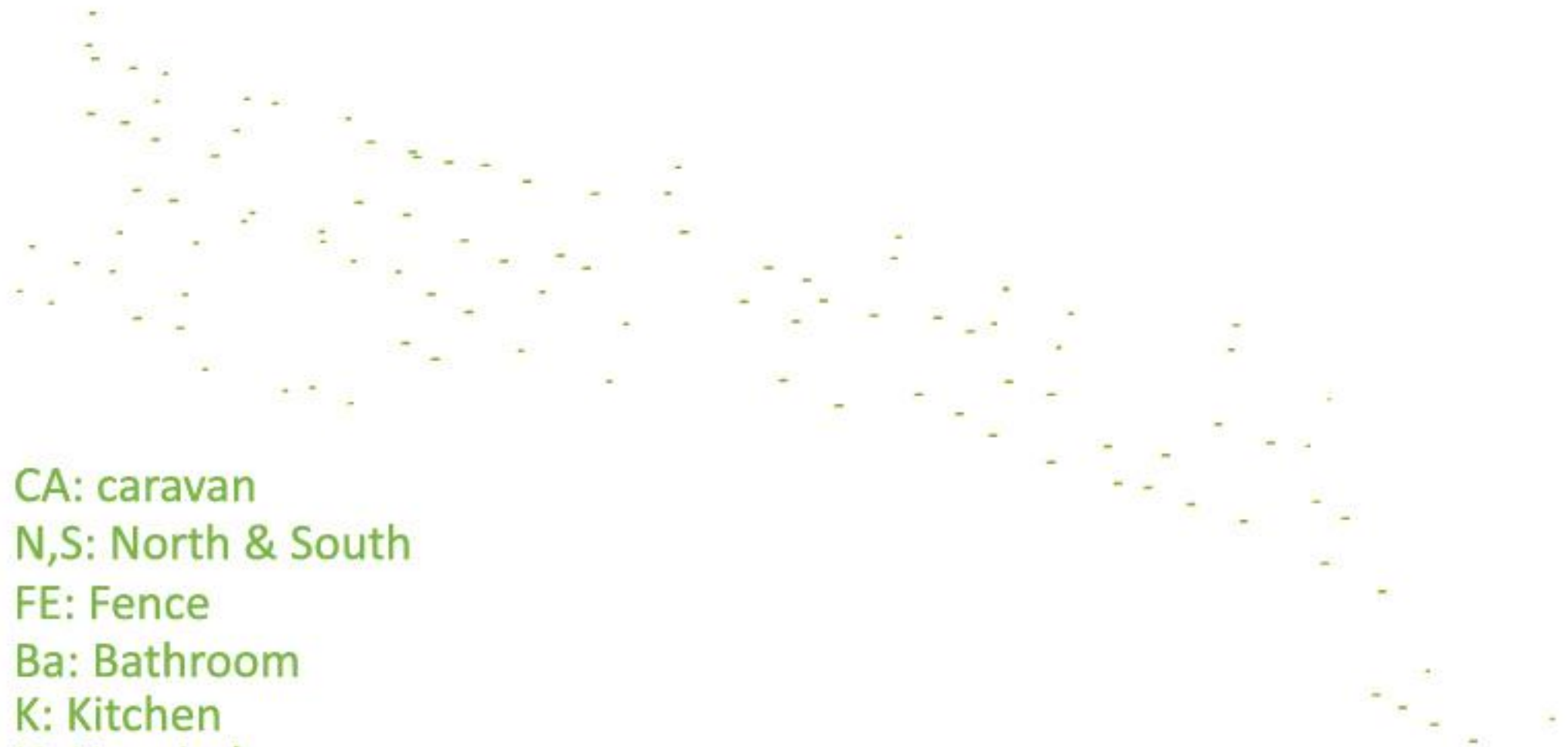

CA: caravan
N,S: North & South
FE: Fence
Ba: Bathroom
K: Kitchen
H: Hospital

The surveying as-built map with codes for all the points for the observed features in site .

3. Address Planning Team

1. Conduct Final As-built Maps

- Create draft manual drawings
- UN registration number for each Household
- Represent the maps as CAD as-built layout

2. HH Plots Remarking

- Specifying the status for each HH/plot (vacant, available, unoccupied)
- Includes UN registration number/s

3. Address Identification for each household

- On a sequence order
- In English and Arabic
- For Implementation Team

Ex: D09 B04 H15

District Number

Block Number

Household Number



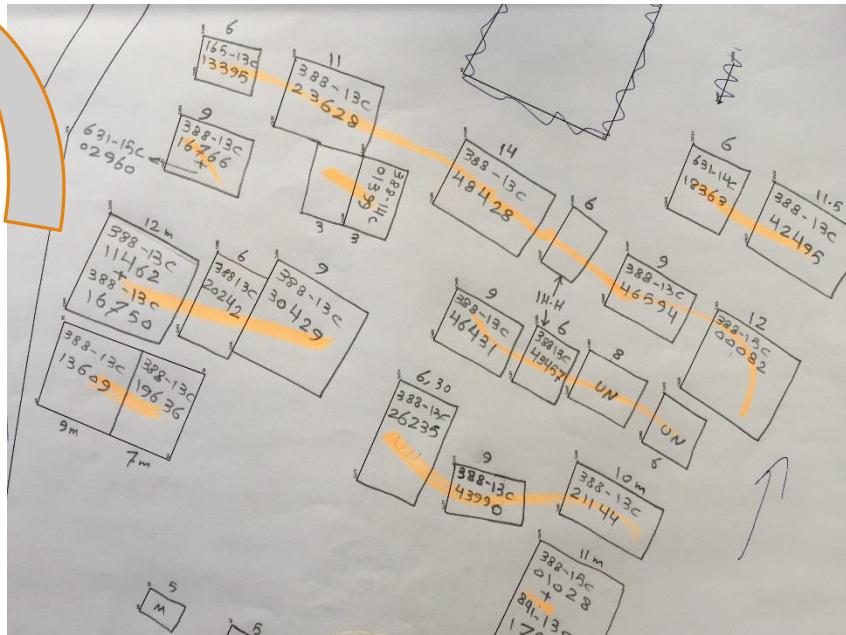
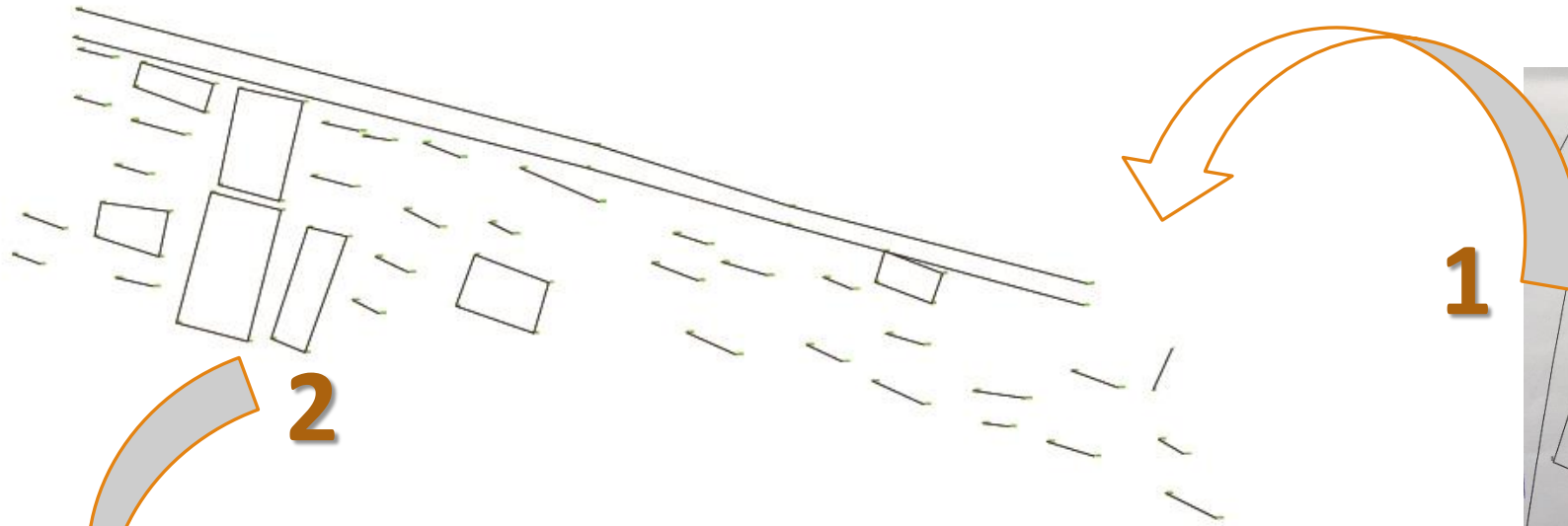

Drawing the final As-built layouts process for each blocks – Addressing and planning team

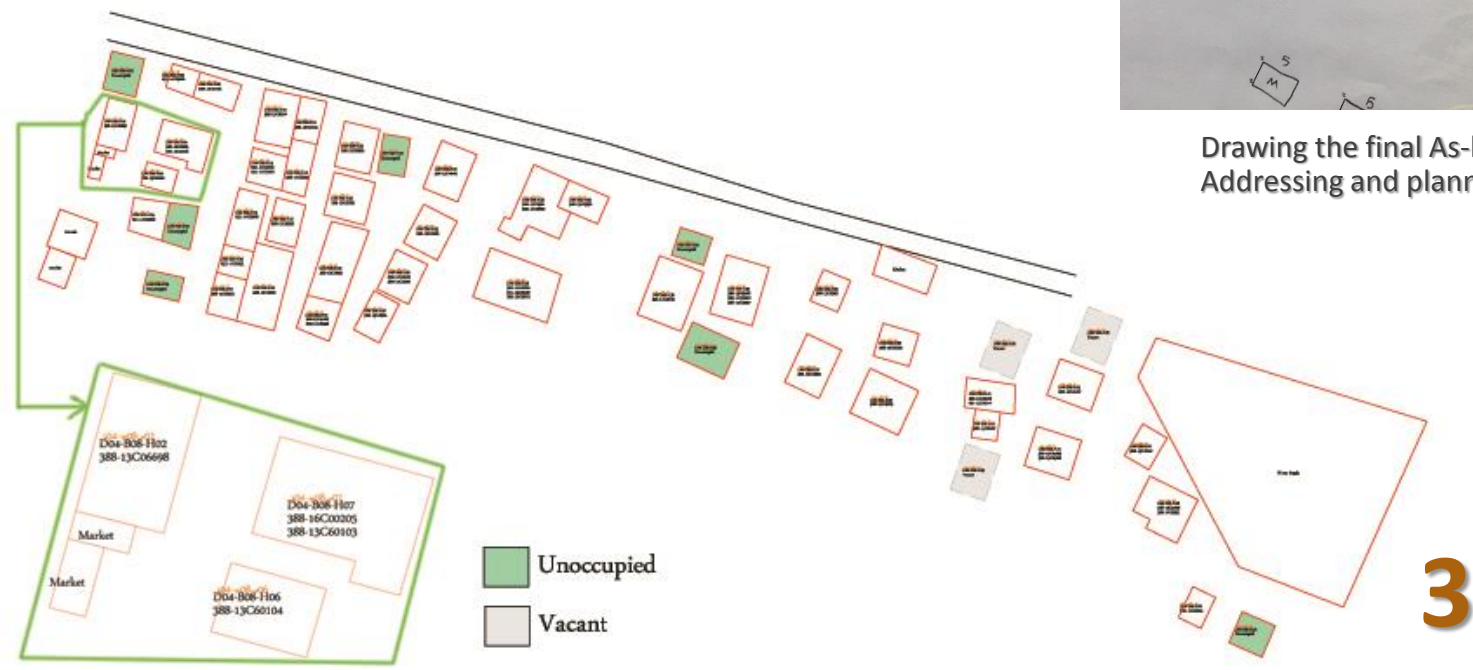
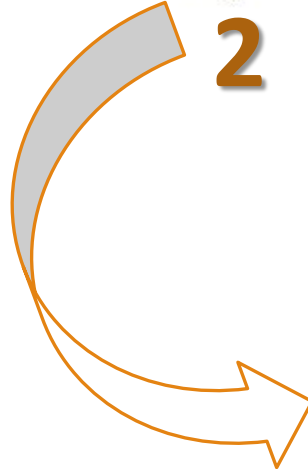



7.5 m

10 m

Available Plots for future and sustainable urban expansion

Project: Address Roll out for Households					
Zaatari Camp, Shelter & Site Planning Unit					
	District#	4			
	Block#	8			Unoccupied: presence
	Date:	25/2/2016			
HH Address (English)	HH Address (Arabic)	Case ID	Remarks(Plot occupied / unoccupied/ available)	Position X	Position Y
D04-B08-H01	01-08-04	Unoccupied	Unoccupied	274870.1394	189698.2939
D04-B08-H02	02-08-04	388-13C06698	Occupied	274868.6392	189687.8730
D04-B08-H03	03-08-04	Unoccupied	Unoccupied	274877.4910	189654.3158
D04-B08-H04	04-08-04	Unoccupied	Unoccupied	274881.7978	189666.2679
D04-B08-H05	05-08-04	631-14C00842	Occupied	274874.4288	189668.5862
D04-B08-H06	06-08-04	388-13C60104	Occupied	274876.2956	189677.1379
D04-B08-H07	07-08-04	388-16C00205, 388-13C60103	Occupied	274881.2984	189683.5703
D04-B08-H08	08-08-04	631-14C03880	Occupied	274880.5742	189697.4642
D04-B08-H09	09-08-04	388-13C64156	Occupied	274888.1272	189695.5014
D04-B08-H10	10-08-04	388-13C60174	Occupied	274901.6553	189690.3192
D04-B08-H11	11-08-04	388-13C64155	Occupied	274907.9041	189687.6430
D04-B08-H12	12-08-04	388-14C02005	Occupied	274906.0976	189677.2775
D04-B08-H13	13-08-04	631-14C04724, 631-14C00840	Occupied	274898.9710	189679.3181
D04-B08-H14	14-08-04	388-13C60102	Occupied	274903.0676	189667.7311
D04-B08-H15	15-08-04	631-14C00846	Occupied	274895.6723	189669.0809
D04-B08-H16	16-08-04	631-14C04731	Occupied	274892.7517	189659.4428
D04-B08-H17	17-08-04	388-15C00622	Occupied	274890.7318	189653.3167
D04-B08-H18	18-08-04	388-13C40581	Occupied	274899.3163	189653.5329
D04-B08-H19	19-08-04	388-13C57109, 388-15C00938	Occupied	274910.1816	189647.9960
D04-B08-H20	20-08-04	388-13C48901	Occupied	274913.0255	189657.6127
D04-B08-H21	21-08-04	388-13C39136	Occupied	274915.4319	189672.0377
D04-B08-H22	22-08-04	388-13C32810	Occupied	274917.4737	189682.8200
D04-B08-H23	23-08-04	Unoccupied	Unoccupied	274925.6264	189681.3074
D04-B08-H24	24-08-04	388-13C46761	Occupied	274936.7207	189678.0610
D04-B08-H25	25-08-04	388-13C12400	Occupied	274932.9069	189665.6863
D04-B08-H26	26-08-04	388-13C12400	Occupied	274927.1157	189656.7281

4. "Data Extraction"

- CAD drawings to Excel sheets



November 2015



January 2016

4. Address Implementation Team

1. Address Installation

- Installing the address of each HH
- Using a special predesigned plates and specific paints
- check the UN registration number and all attached data for each HH







2. Street Addressing

- provided streets maps from UNHCR
- On-Site check for any change
- typing the names of each street

3. Final check-up

- on site
- for the whole district
- Work submission



Project Challenges & Site Management

Community accepting and understanding the project actions and activities

- NRC CRT Messaging Support
- Coordination with UNHCR field focal points and IRD CMs on site, by community gathering in each district.

Trust problem

- On-site CRT Support
- Overall site work – by time

Uncontrolled Caravans movements by individuals

- Coordination with UNHCR field focal points and IRD CMs on site, by community gathering in each district. Addressing System.
- Linking HH to infrastructure networks

Base Data and references were not updates to the site

- Multi resource information and data-base in compressing with site

The project covers the whole Zaatari Camp (12 Districts = 5.22 km² = more than 14,000 HH)

- Scheduled work plan – and teams cooperation work
- Systemize work and development

Project Achievements

1- Project Progress Documentation

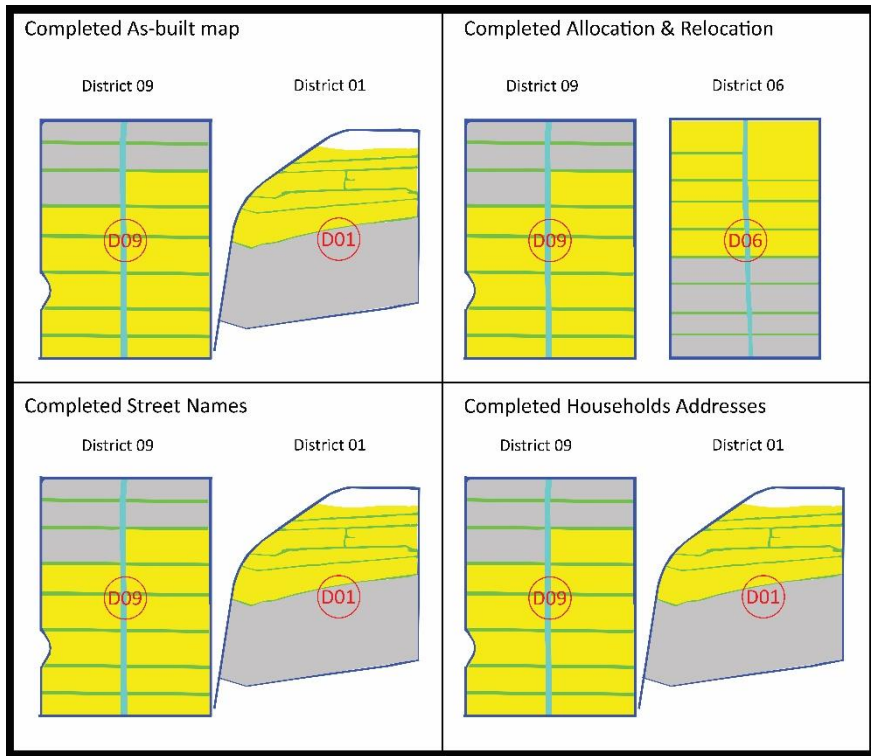

Work Progress master plan/s

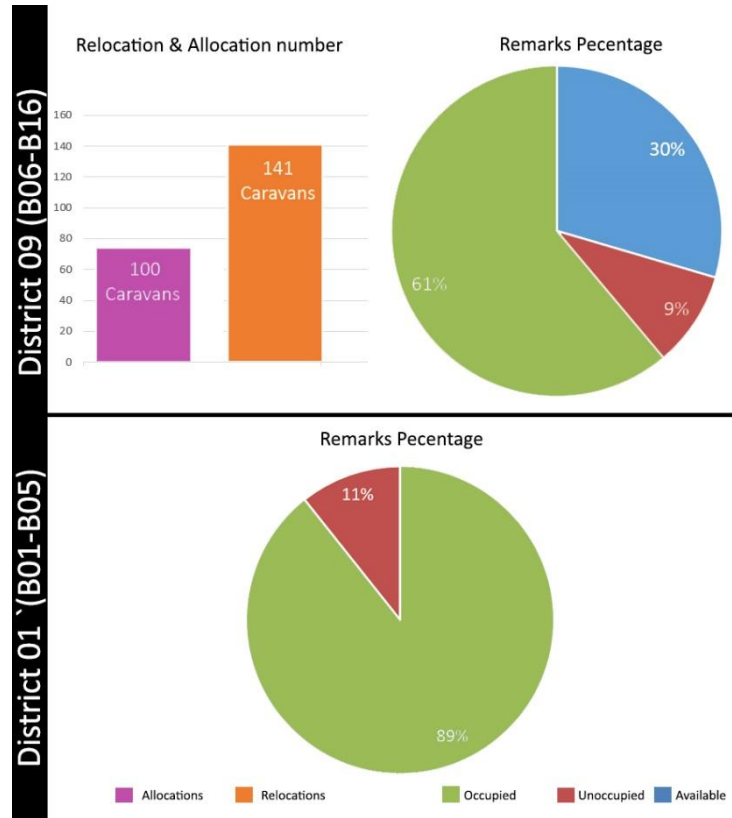

Cumulative Quantities Diagrams

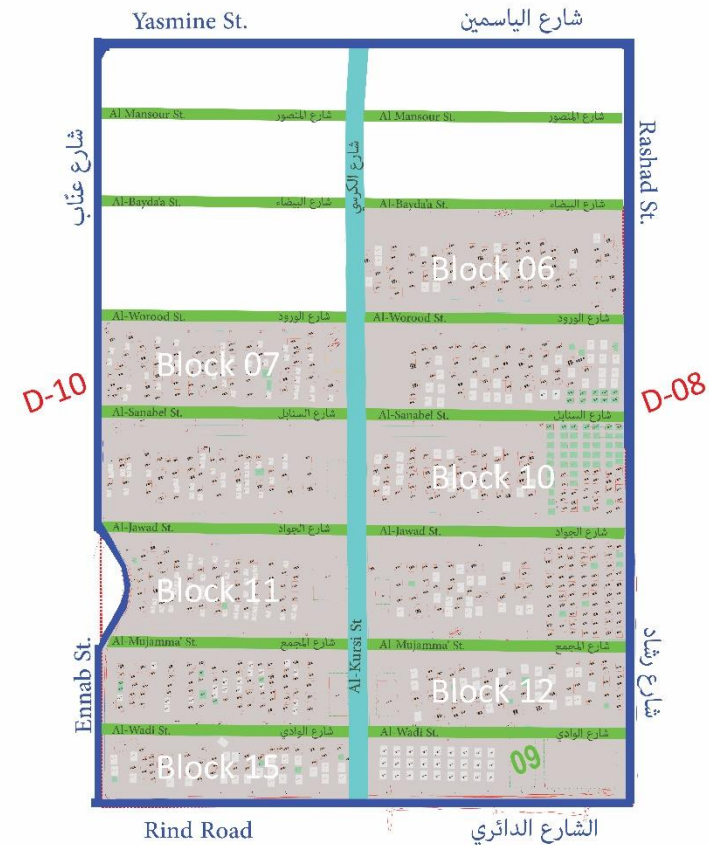

Cumulative Quantities Diagrams

TOTAL IN EACH DISTRICT ZAATARI CAMP

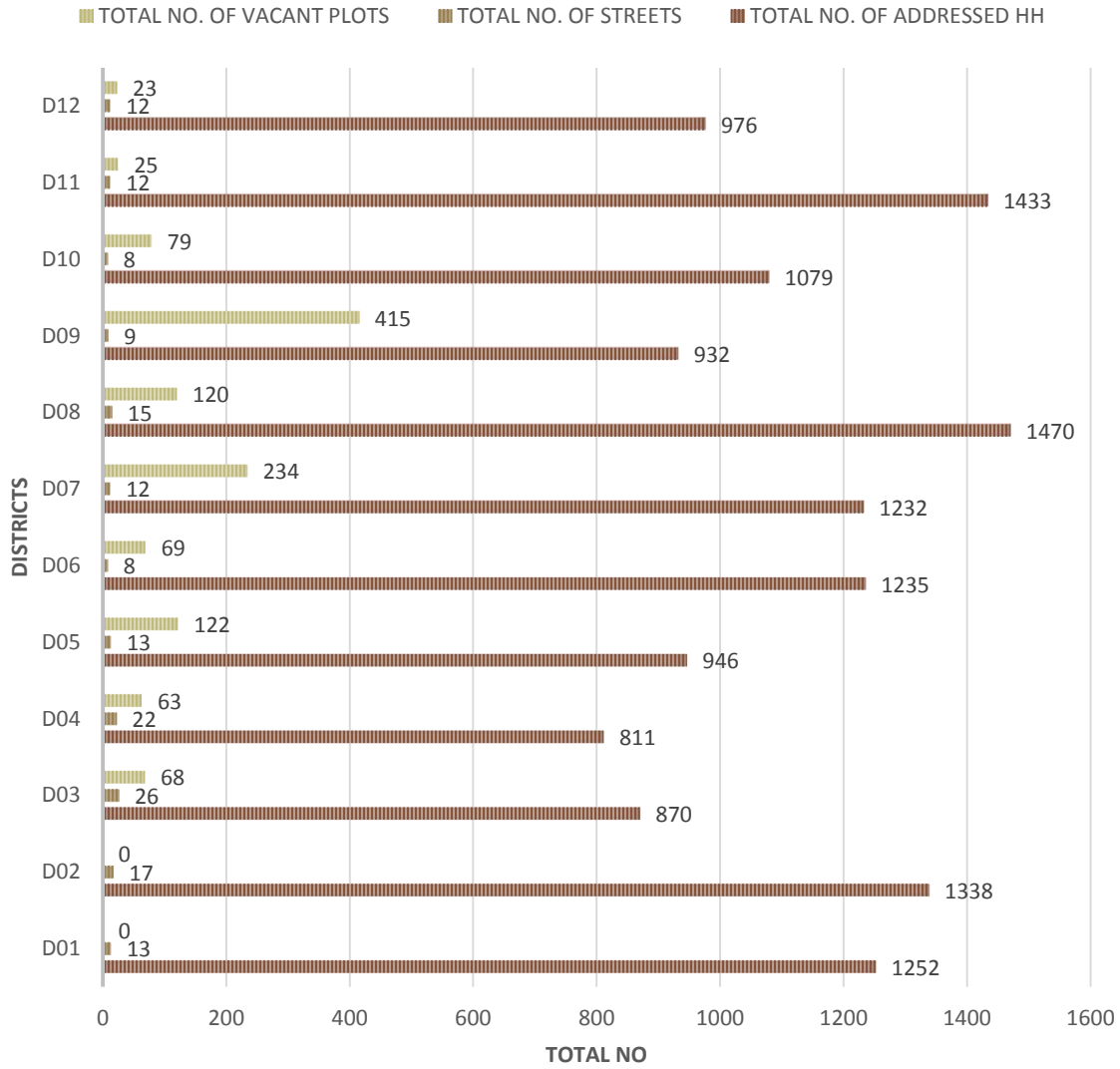

TOTAL IN EACH DISTRICT ZAATARI CAMP

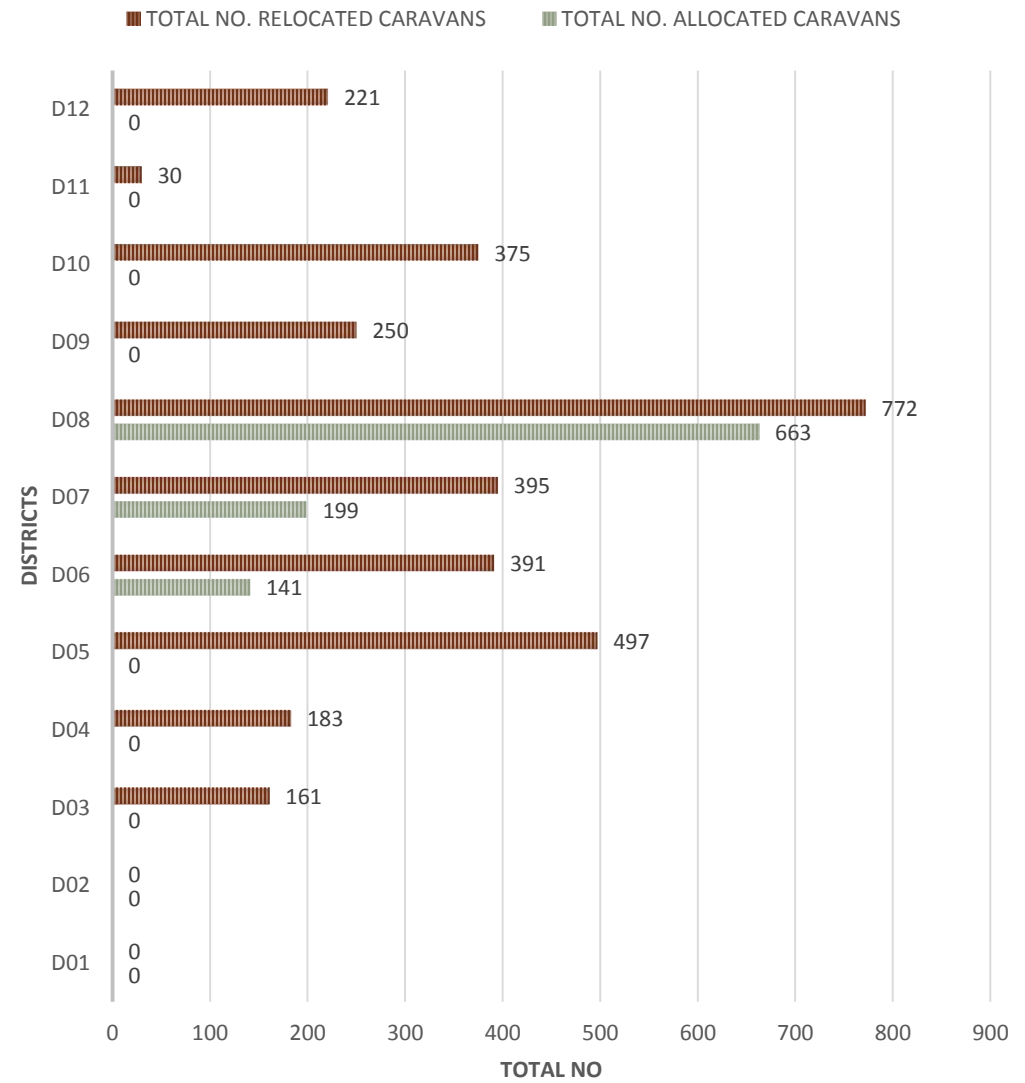

Legend

Done in

-  April-July
-  August
-  September
-  October
-  November
-  December
-  January
-  February
-  March

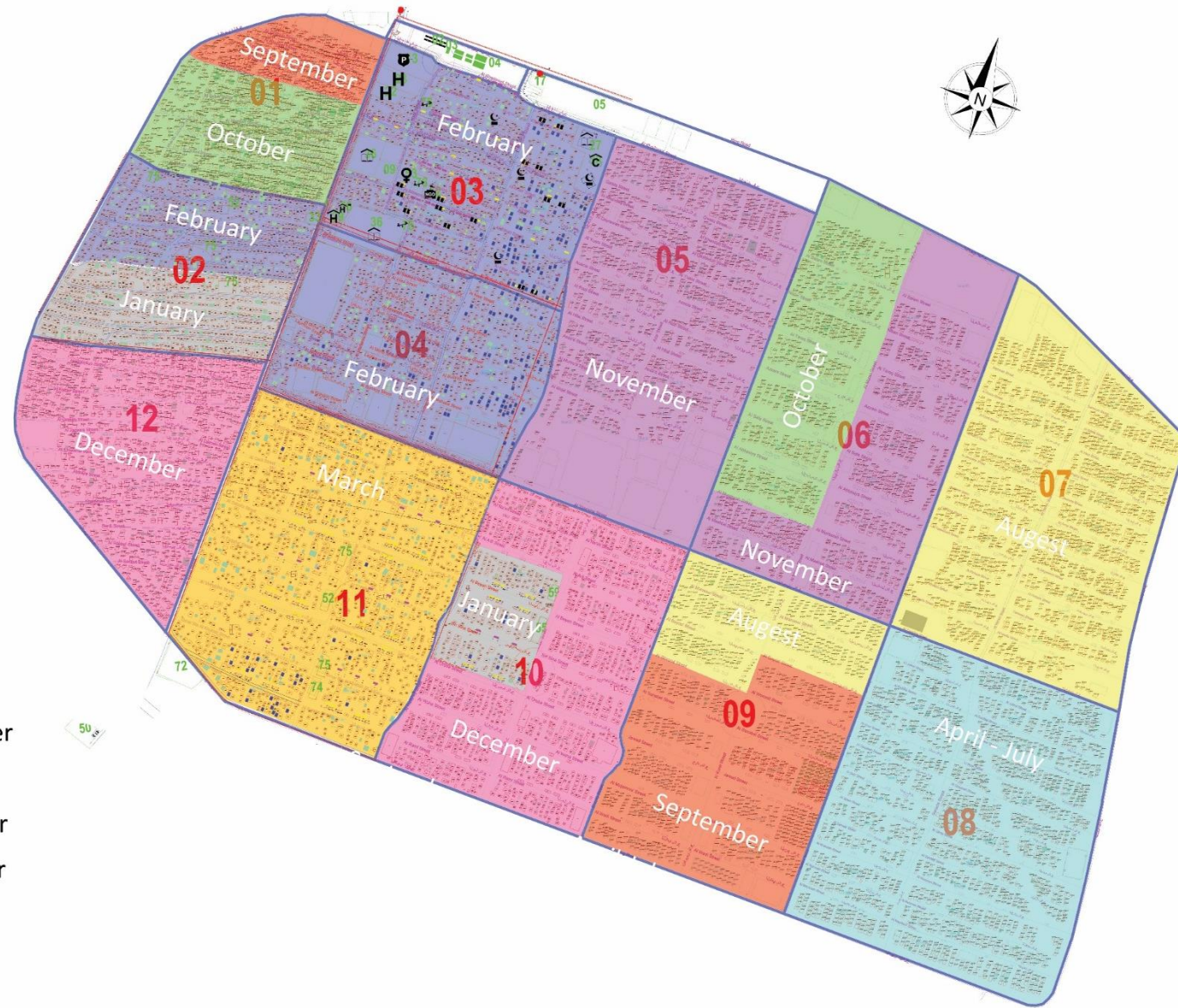

Restructuring Zaatari Camp Project Time progress – master plan from monthly report / till April 2016

2- Restructuring Project On-site

- **Accessibility for each Household**
- **Improved Households layout to have a healthy and safe environment for each family**
- **All HH have a reachable address for refugees and visitors**
- **All the main and secondary streets have a clear and visible name**
- **Proper arrangements of shelters and a 'final' layout plan of the camp to accommodate the Syrian refugees' population growth.**



Before



After

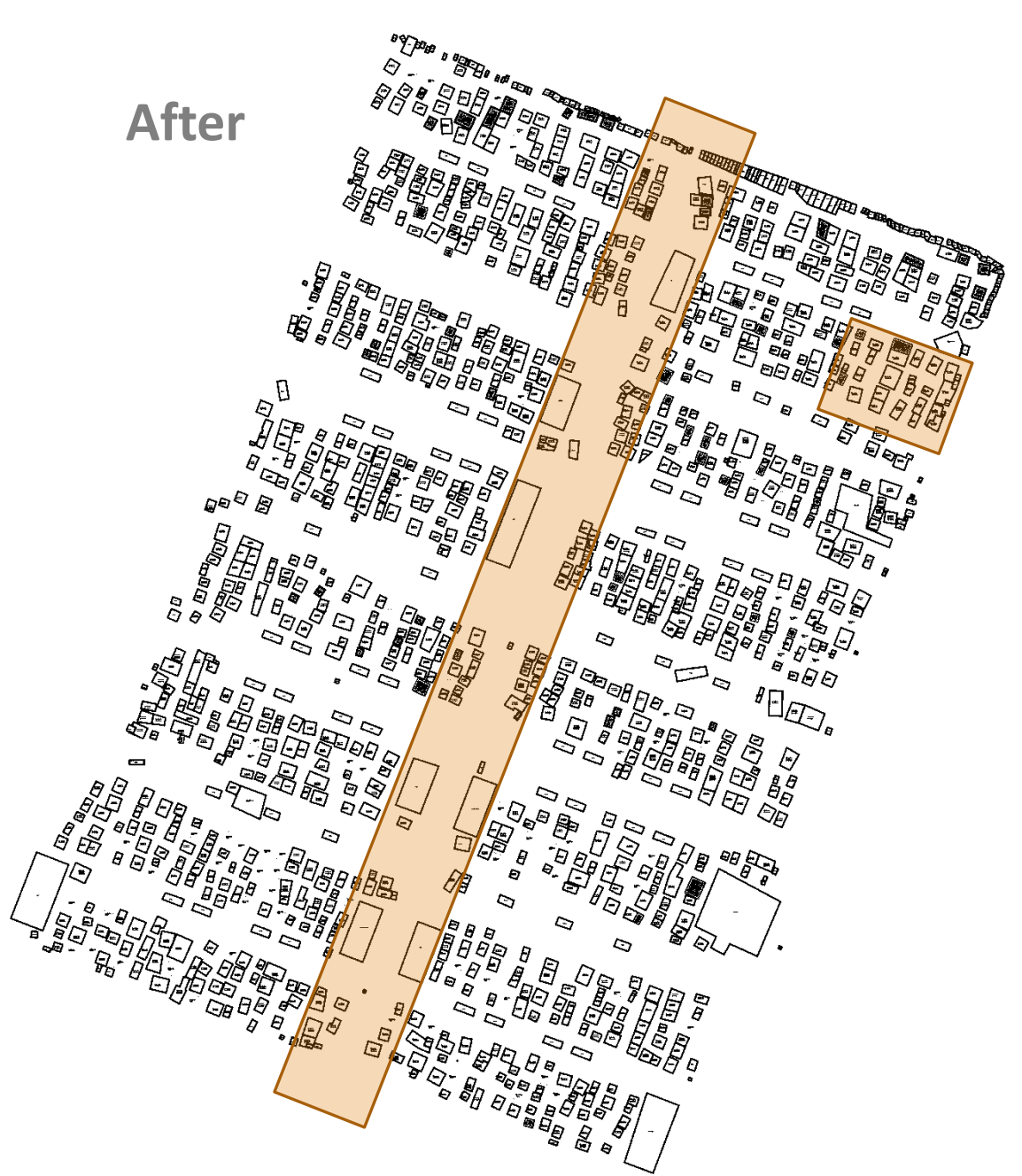

Before and after Restructuring Project - District 10







Beneficiaries' Feedback & Project Evaluation

1. General Feed Back

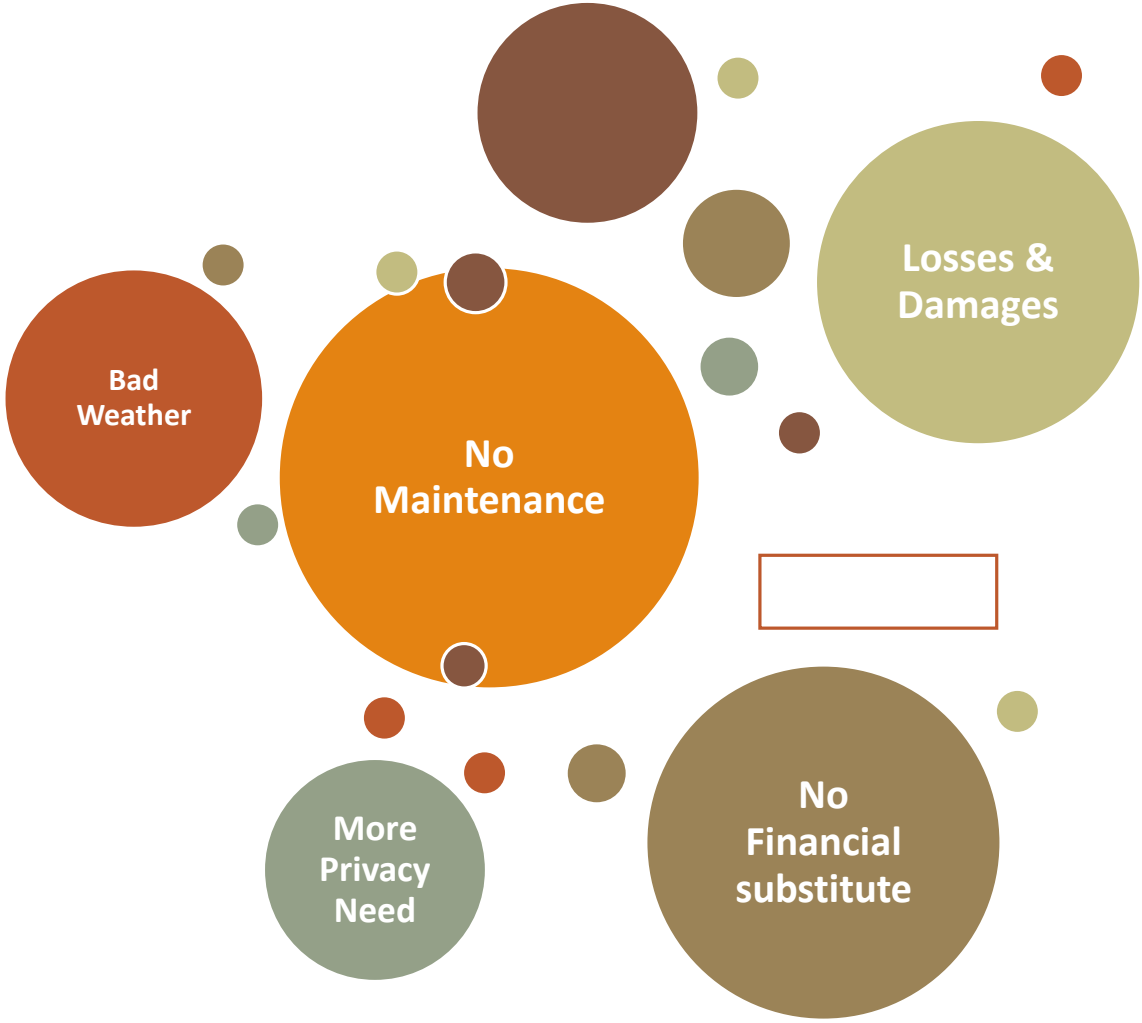
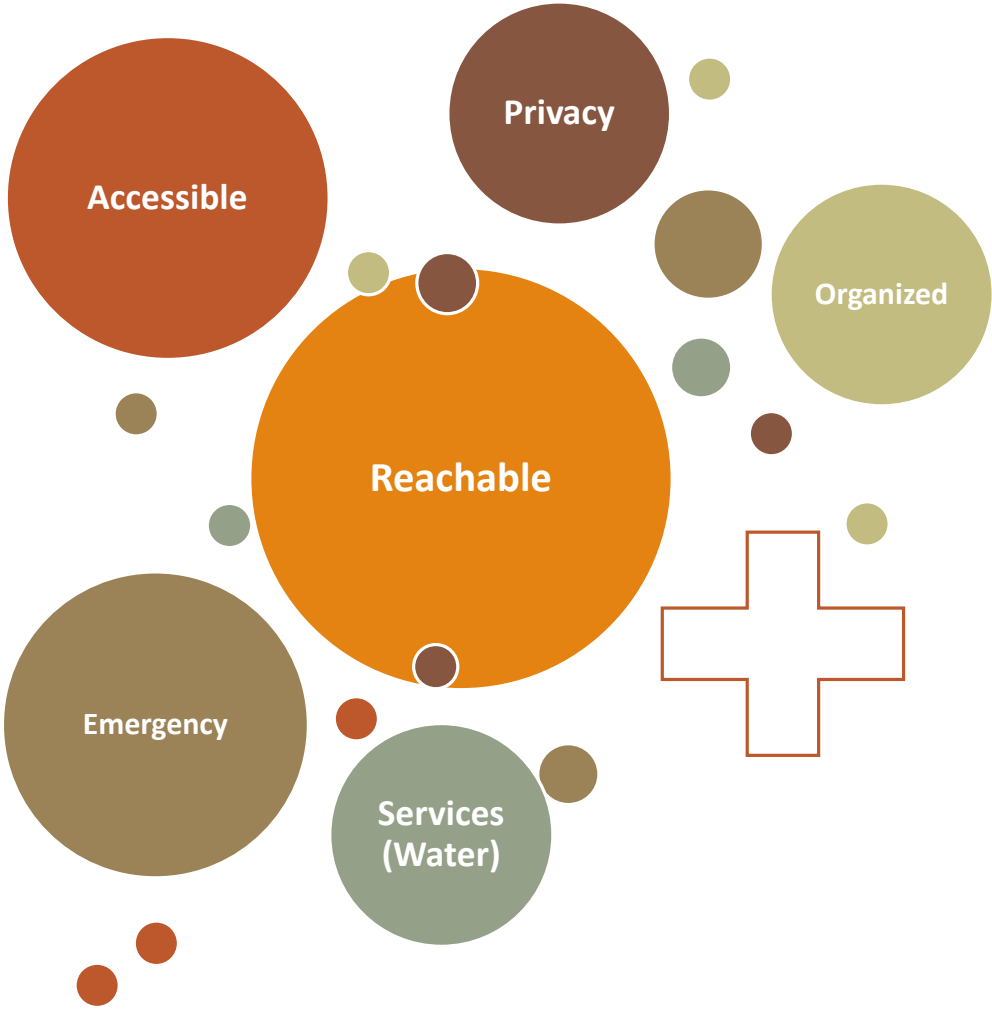

2. NRC Project Implementation Performance Evaluation

Pursuit NRC to providing a better service to the beneficiaries and in order to reflecting their opinions and their needs on our processes and to avoid falling in the same errors, CRT selected **50** random H.H and conducted **50** assessments to getting beneficiaries feedback about how was NRC team performance during the restructuring process in **District 08**.

And in April 2016 NRC team selected another **50** random H.H and conducted **50** assessments to getting beneficiaries feedback about how was NRC team performance during the restructuring process in **District 10**.

Beneficiaries were asked four main questions as follows:

**BENEFICIARIES FEED BACK DIAGRAMS –
DISTRICT 08 / JULY 2015**

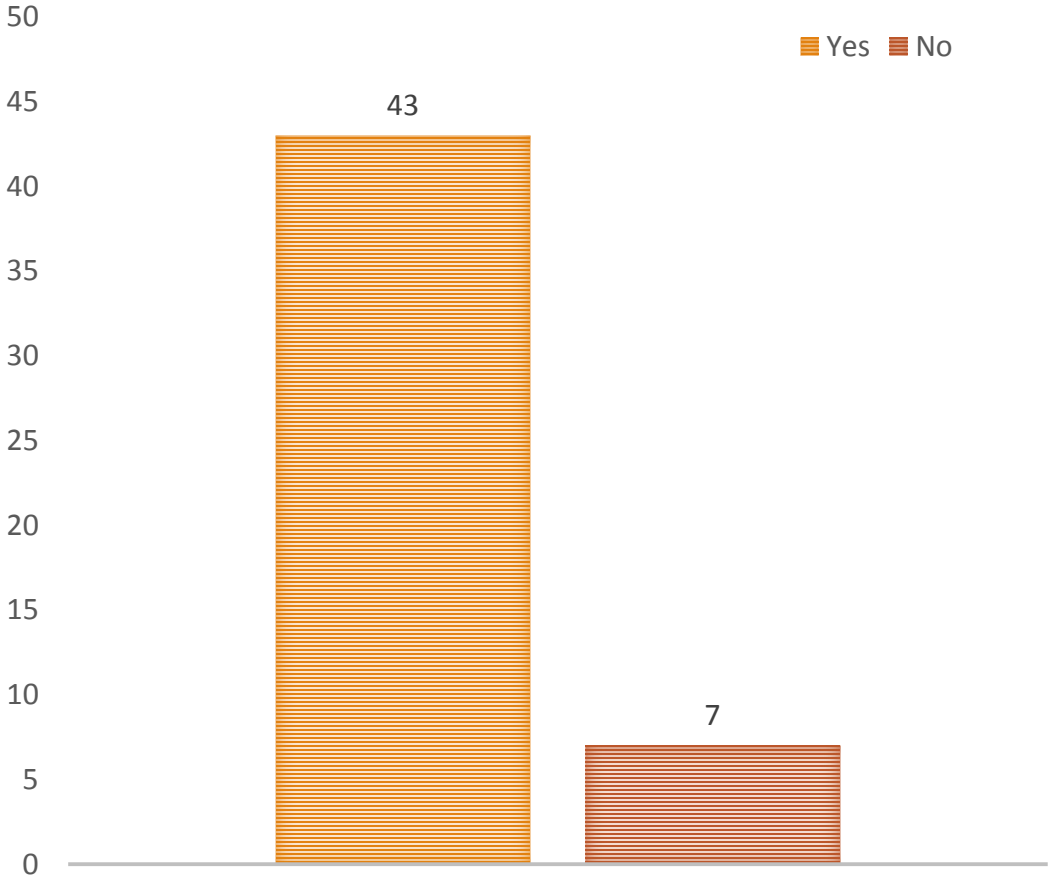

**BENEFICIARIES FEED BACK DIAGRAMS –
DISTRICT 10 / MAY 2016**

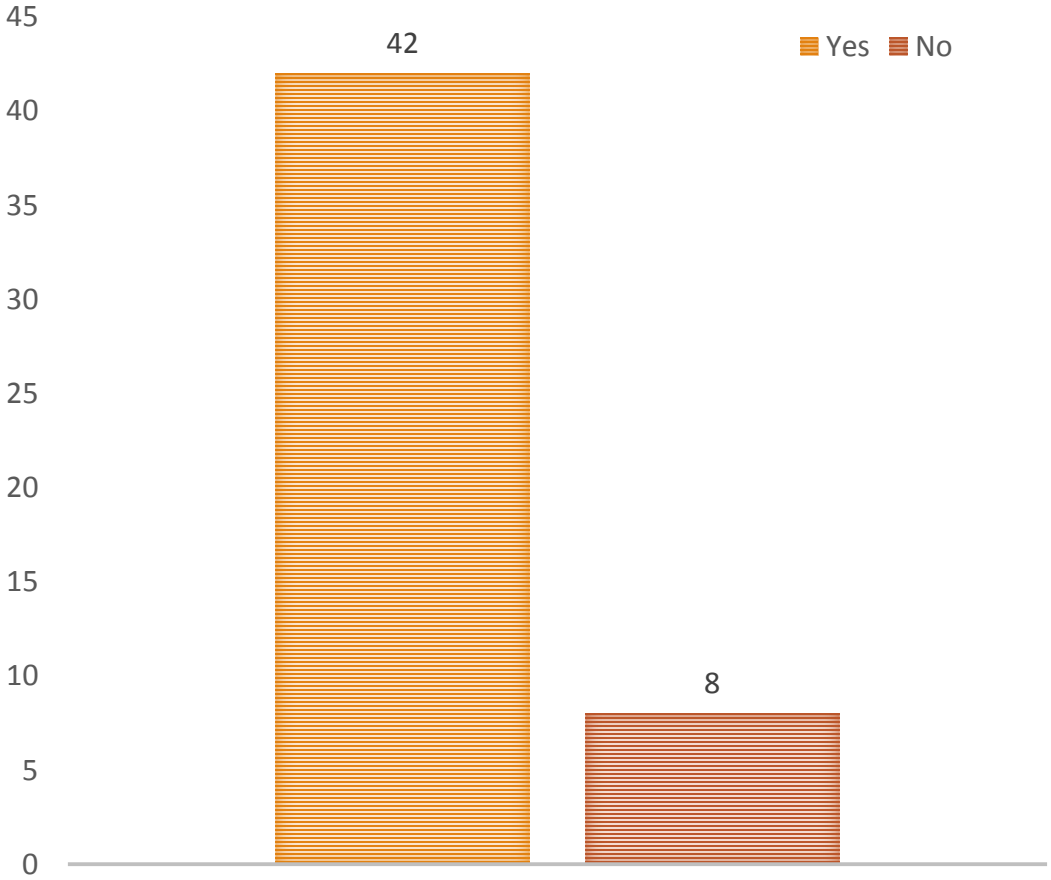

1. DO YOU CONSIDER PUTTING AN ADDRESS SIGNS ON YOUR CARAVAN USEFUL FOR YOU?

**BENEFICIARIES FEED BACK DIAGRAMS –
DISTRICT 08 / JULY 2015**

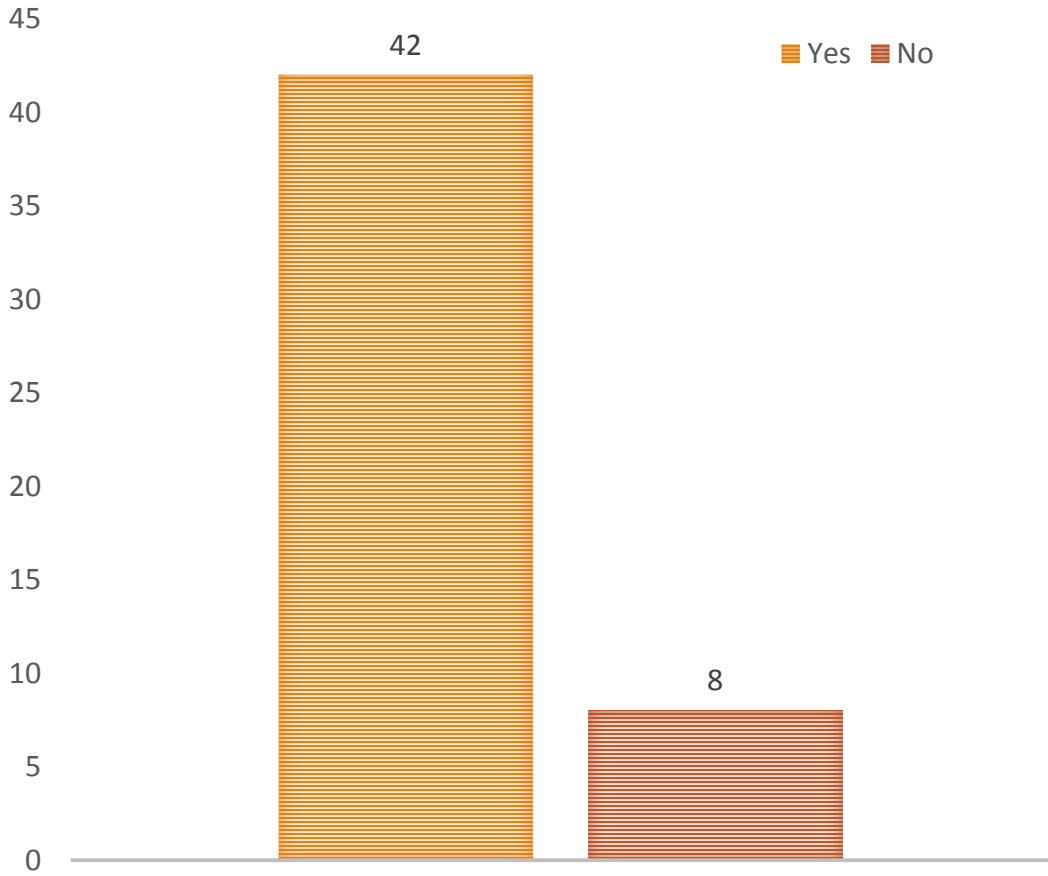

**BENEFICIARIES FEED BACK DIAGRAMS –
DISTRICT 10 / MAY 2016**

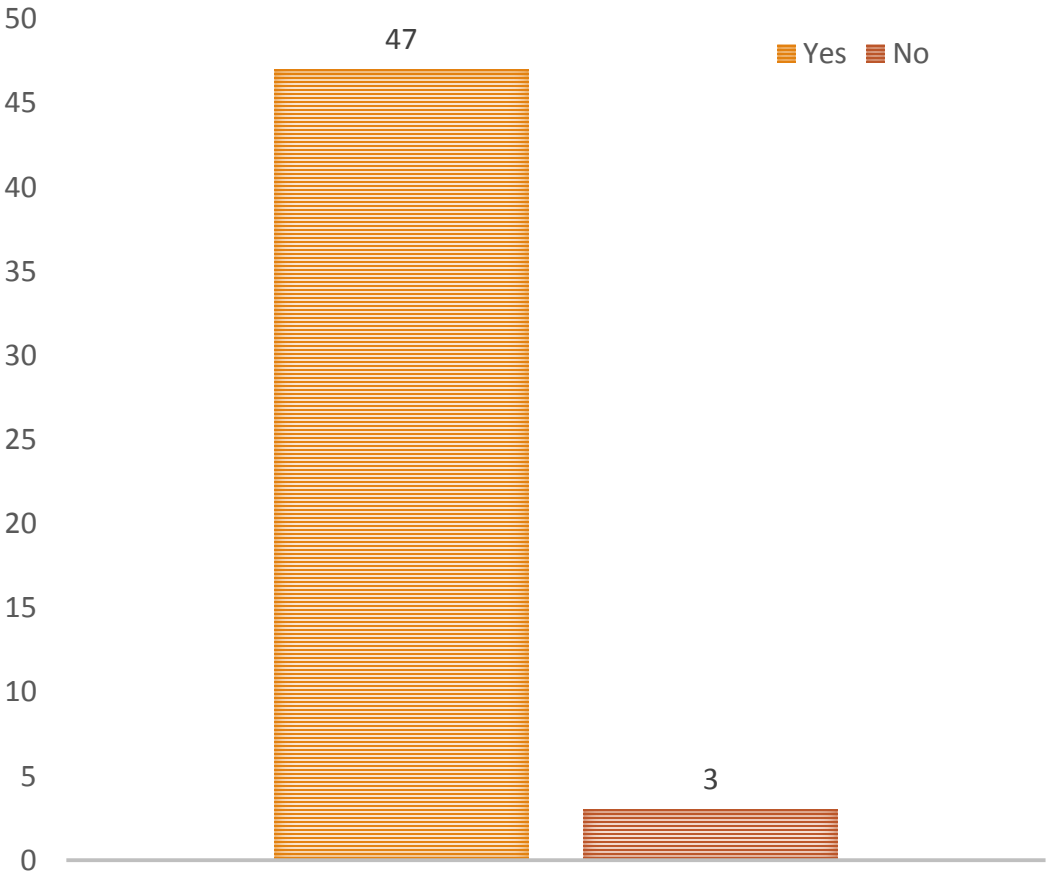

2. IN YOUR OPINION, DO YOU THINK THAT THE NRC TEAM HAS IMPROVED AND REORGANIZED THE STREETS IN YOUR DISTRICT?

**BENEFICIARIES FEED BACK DIAGRAMS –
DISTRICT 08 / JULY 2015**

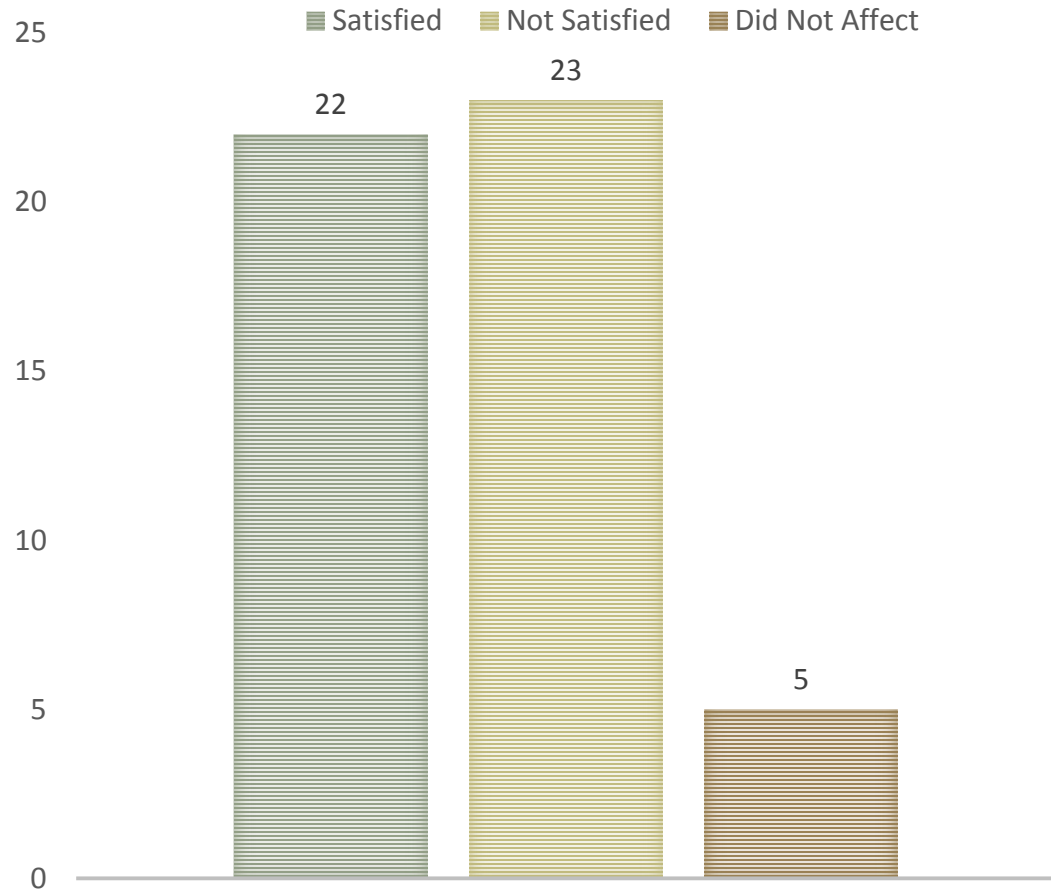

**BENEFICIARIES FEED BACK DIAGRAMS –
DISTRICT 10 / MAY 2016**

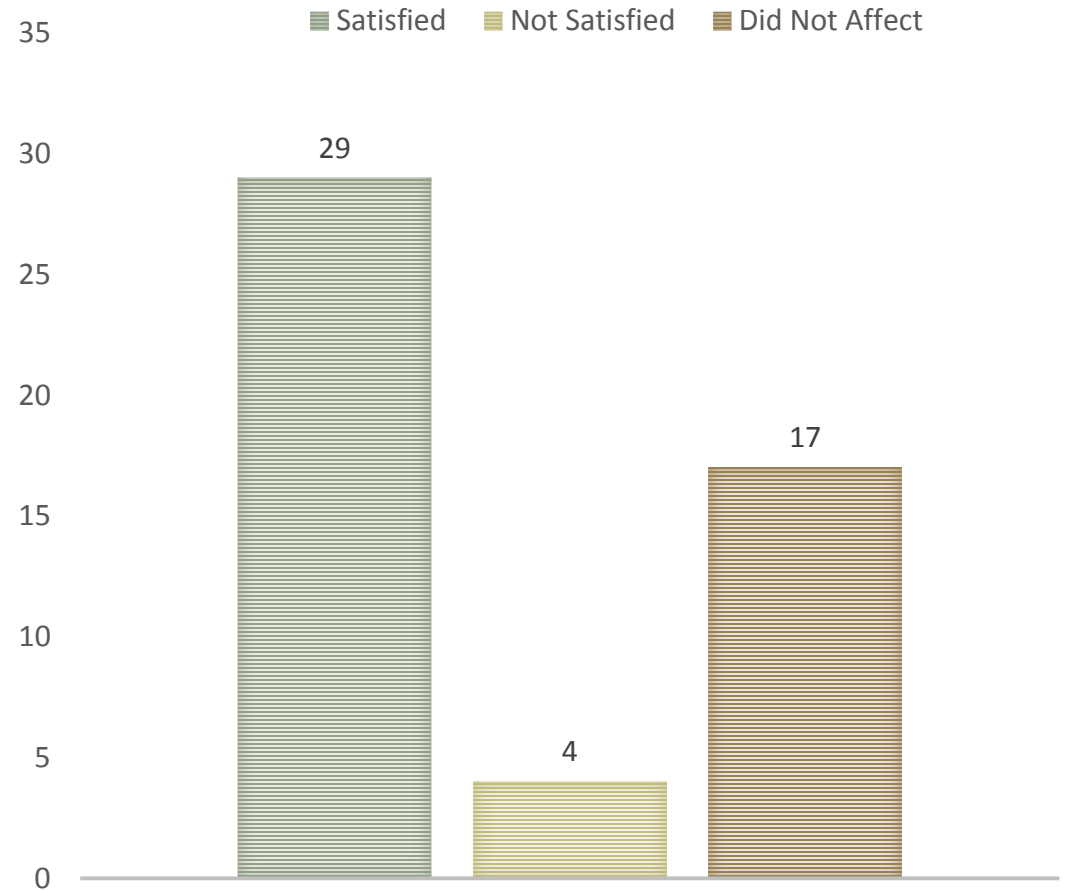

3. WERE YOU AFFECTED POSITIVELY OR NEGATIVELY FROM RELOCATING YOUR CARAVAN / TENT? PLEASE EXPLAIN?

**BENEFICIARIES FEED BACK DIAGRAMS –
DISTRICT 08 / JULY 2015**

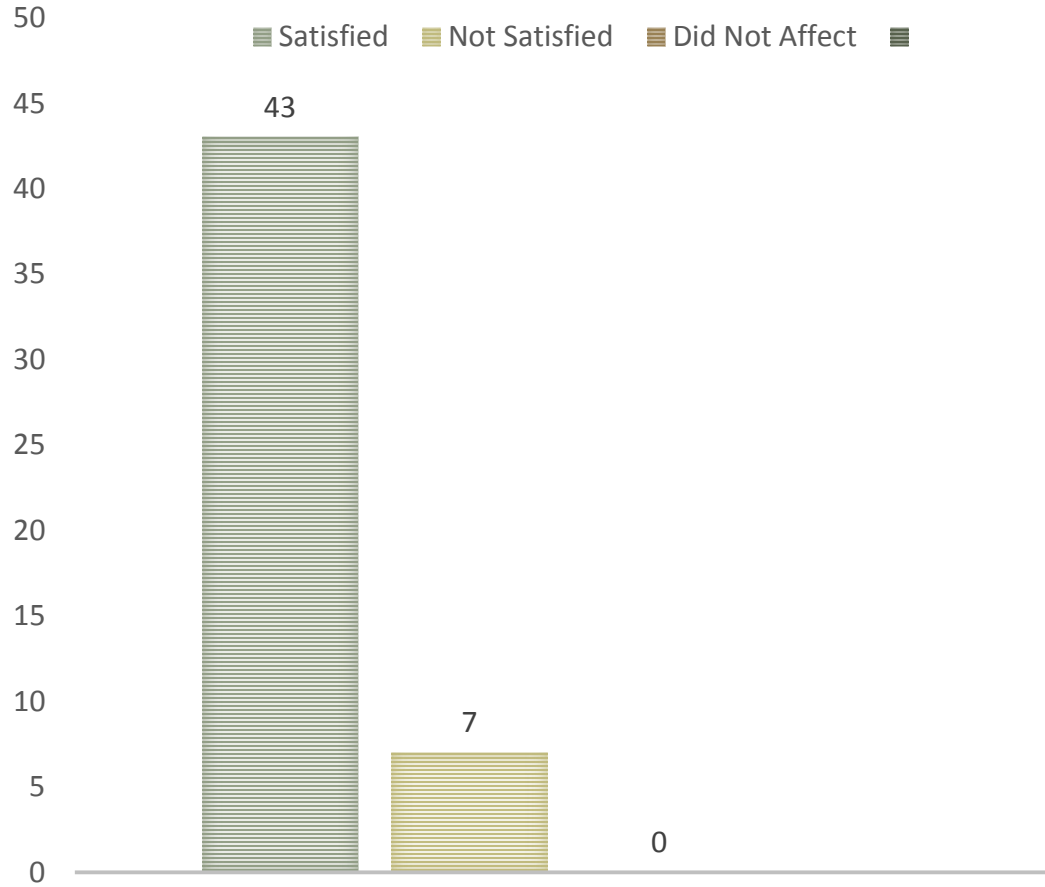

**BENEFICIARIES FEED BACK DIAGRAMS –
DISTRICT 10 / MAY 2016**

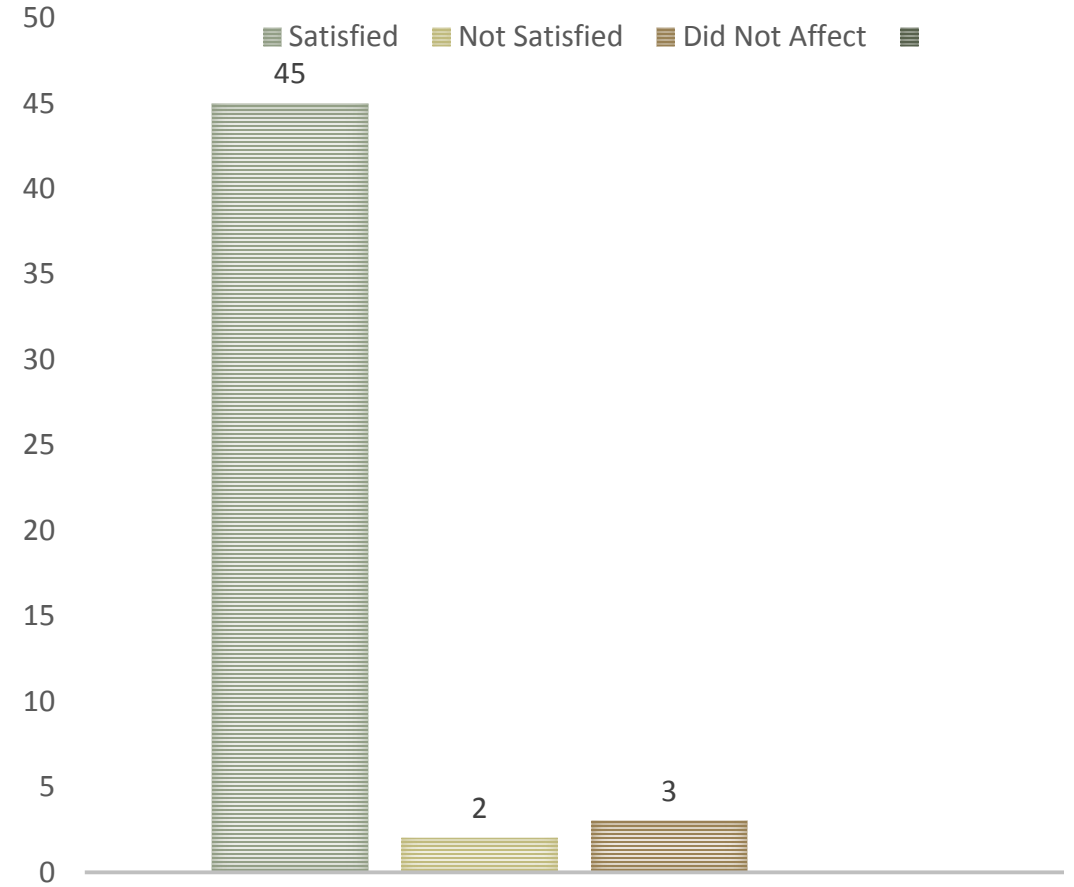

4. ARE YOU SATISFIED FROM THE PERFORMANCE OF NRC TEAM DURING RESTRUCTURING PROCESS IN YOUR DISTRICT? PLEASE EXPLAIN?

3. Project Evaluation & Monitoring

NUMBER OF MOVED CARAVANS INDIVIDUALLY
AFTER RELOCATION / 50 RANDOM BENEFICIARIES
ASSESSMENT FROM D10

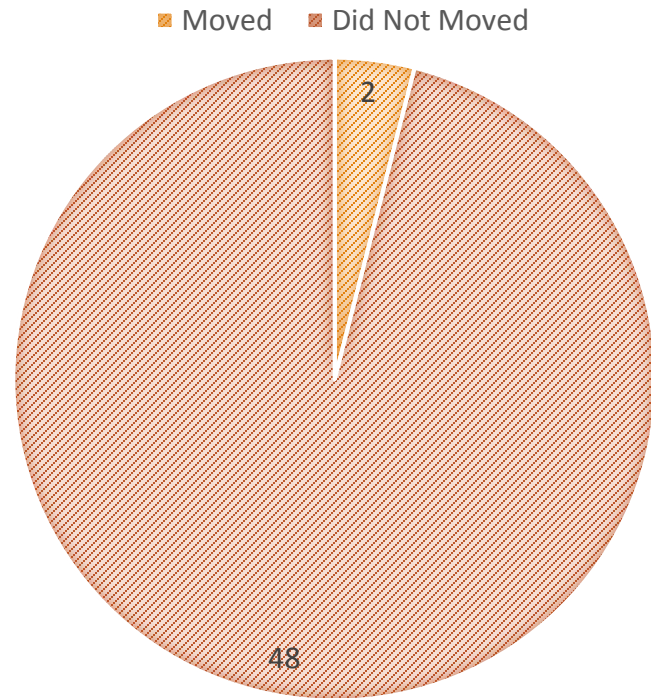

(1)

SUCCESS RATE/ 50 RANDOM BENEFICIARIES
ASSESSMENT FROM D10

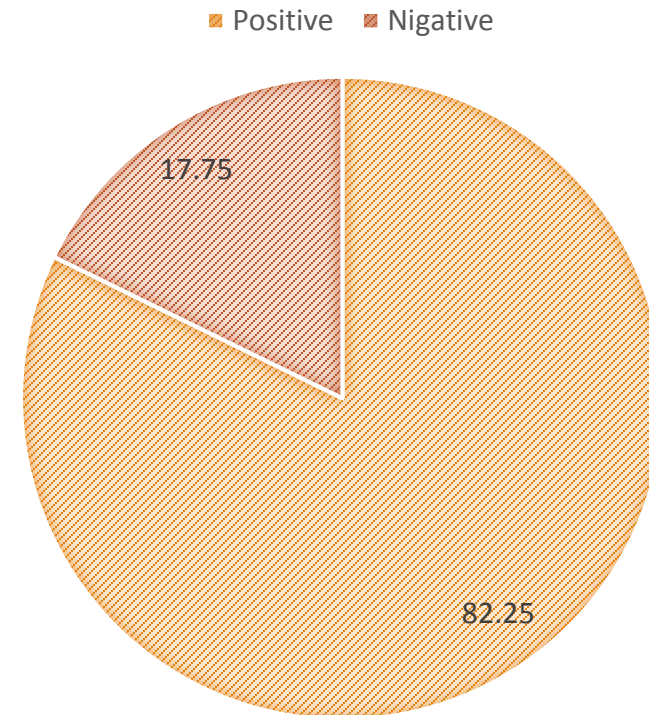

(2)

Zaatari Refugee Camp

MAFRAQ . JORDAN

GENERAL INFRASTRUCTURE

- | | |
|-----------------------|-----------------------------|
| ⚡ Assembly point | 🏠 Hotel |
| 🏥 Clinic | 🏠 House |
| 🏢 Community building | 🏢 Infrastructure |
| 🏢 Diplomatic mission | 🚑 Mobile clinic |
| 🏠 Distribution site | 🕌 Mosque |
| 🏠 Food warehouse | 🏢 NGO office |
| 🏢 Government office | 🚓 Police station |
| 🏠 Health facility | 🎓 School |
| 🏠 Health post | 🏢 UN compound/office |
| 🏠 Hospital | 🛒 Supermarket |
| 👤 Registration | 🎡 Children playground |
| 🚏 Bus Station | 👮 Gendarmerie |
| 🏠 Warehouse | 🏃 Sports Center |
| 🎓 Youth Center | 🏠 Informal Education Center |
| 🅑 Parking Area | 📡 Telecommunications Center |
| 👩 Women Center | ⚡ Transformer |
| 👮 Gendarmerie station | |

WATER, SANITATION & HYGIENE

- | | |
|------------------------|------------------------------|
| 🕒 Borehole | 🌊 Spring Water |
| 🚽 Communal latrine | 🚰 Submersible pump |
| 🚽 Latrine cabin | 🚽 Toilet |
| 🚰 Potable water | 💧 Water reservoir |
| 🚰 Potable water source | 🚚 Water trucking |
| 🚰 Sanitation | 🕒 Well |
| 🚿 Shower | 🏠 Wastewater Treatment Plant |
| 🗑️ Solid Waste | |

EDUCATION

- | |
|------------------------------|
| 🎓 School yard + Sports field |
| 🎓 Vocational Training centre |



LAYERS

CF_	Camp Facilities
ADDRS_	Address
BOUND_	Boundary
HH_	Household
IF_	Informal Facilities
RN_	Road Network
SN_	Stormwater Network
CTR_	Contour Line
WN_	Water Network
WWN_	Waste Water Network
ELEC_	Electricity
SEC_	Security
DIM_	Dimension Line
LE_	Layout Elements
SM_	Sidewalk Materials
SW_	Solid Waste

DRAWING DESIGNATION:
Zaatari Masterplan

SCALE : To Fit

ARCH/PSP NAME: Mohamed Jertila
Ghada Barakat

MODIFIED DATE : 02/05/2016

Conclusions

Number of HHs visited	14096
Number of relocated shelters	3275
Number of HHs upgraded with a new shelter	1450
Number of HHs that require a new shelter	837
Number of HHs assisted with an address number	14917
Number of occupied plots	12480
Number of unoccupied plots	1201
Number of vacant plots	1236
Number of streets within the ring road	152
Number of blocks in all districts	193

THANK YOU